

TillesCenter

for the Performing Arts LIU Post

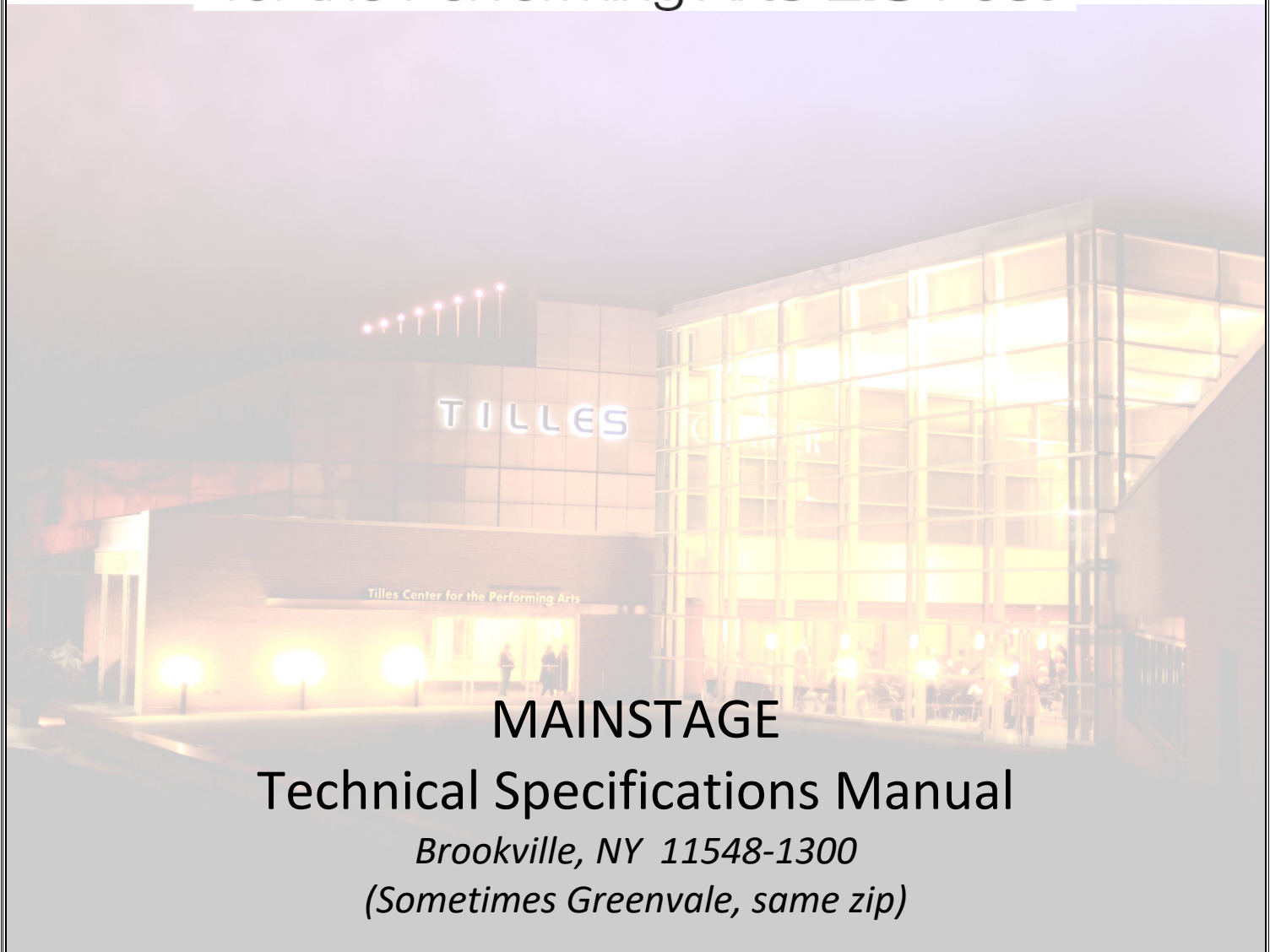

MAINSTAGE

Technical Specifications Manual

Brookville, NY 11548-1300
(Sometimes Greenvale, same zip)

Last Updated September 2022
Prepared By: Thomas A. Pascarella,
Director of Facilities and Production Services

TABLE OF CONTENTS

Basic Contact Information and Venue Location

- 1.0 General Description
- 1.1 Basic Contact Information, Address, and GPS Coordinates
- 1.2 Key Tilles Center Staff
- 1.3 Directions to the Venue/Campus
- 1.4 Local Area Map
- 1.5 Campus Map
- 1.6 Facility Map

Configurations & Specifications

- 2.0 Configurations & Capacities
- 2.1 General Backstage Information
- 2.2 Hospitality and Front of House
- 2.3 Front of House

Rigging Information

- 3.0 Handy Rigging Measurements
- 3.1 Detailed Rigging Lineset Information and Rep Hang
- 3.2 Soft Goods Inventory
- 3.3 Rigging & Lineset Worksheet
- 3.4 Tilles Dimension Quick List

Lighting, Electrics, and Effects

- 4.0 General Information
- 4.1 Lighting Fixture Inventory
- 4.2 Lighting Accessories Inventory

Audio Information

- 5.0 Main Sound System Specification
- 5.1 General Sound Information
- 5.2 Microphone Inventory
- 5.3 Microphone Accessory & Input Inventory
- 5.4 Processing and Source Inventory
- 5.4 "Sound" Advice

Video & Projection

- 6.0 Video Description
- 6.1 Screens and Projection Dimensions
- 6.2 Video Sources and Inventory

TABLE OF CONTENTS (cont.)

APPENDIX A: Video Image Size Drawings

- A1: Basic Elevation and Cyc Dimensions
- A2: Projection Sizes on Cyc with Projection from Booth
 - a. 16x9 Full Zoom In
 - b. 16x9 Full Zoom Out
 - c. 4x3 Full Zoom In
 - d. 4x3 Full Zoom Out

APPENDIX B: Ground Plans

- B1: Proscenium Ground Plan
- B2: Jazz Ground Plan
- B3: Open Concert/Orchestra Ground Plan

APPENDIX C: Section Drawings

- C1: Proscenium Section (Pit *not* seated)
- C2: Jazz Section with Pit Seated (Pit *not* seated)
- C3: Open Concert/Orchestra Section (Pit Seated)

APPENDIX D: Rigging & Lineset Schedule

- D1: Lineset Schedule Worksheet
- D2: Tilles Center Mainstage RCP

APPENDIX E: Light Plots

- E1: Tilles Repertory Lighting Plot (Full)
- E2: Tilles Repertory Lighting Plot (Overstage Only)

APPENDIX F: Mainstage Seat Charts

- F1: Concert Hall Detailed Seat Chart
- F2: Concert Hall Basic Seat Chart (Reversed/Labeled)

1.0 General Description

Tilles Center is located on the LIU Post campus. The University is a private, independent college offering degree programs in the liberal arts and numerous professional areas.

Since its inaugural season in 1981, Tilles Center has served as the primary cultural resource for the campus and local community by promoting the appearance of professional companies, hosting many of Long Island's major performing arts organizations and presenting performances, lectures and conferences organized by the student body and campus community.

The theatre seats 2,214 with excellent sight lines and acoustics at all seat locations. In addition to its function as a concert hall, the stage is equipped with an orchestra pit, suitable flooring, a computerized lighting system, masking and a limited rigging system to accommodate dance, opera and theatrical productions. A large movie screen and projection equipment for showing movies and slides are also available.

The center is also home to the 506-seat Krasnoff Theater which is ideal for jazz, chamber music, lectures and small theatrical productions.

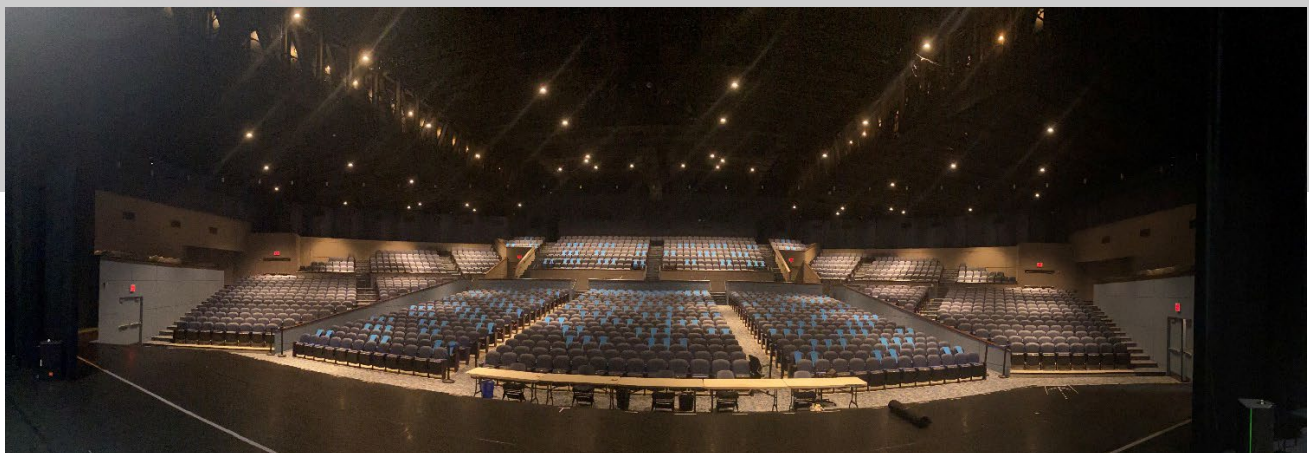

Artists view from the main stage.

1.1: Basic Contact Information and Venue Location

1.1: Mailing Address: Tilles Center for the Performing Arts at LIU Post

Attn: Name, Title or Event

720 Northern Boulevard

Greenvale, NY 11548

GPS Coordinates: [40.817096, -73.597691](#)

Note: USPS, FedEx and UPS deliveries go through campus central receiving; you must allow extra time for items to get to us via these methods. AirEx, most Freight and independent shipping companies deliver directly to the Tilles Center Reception Area or Loading Dock. Certain Mapping Applications do confuse "Tilles Center" with another business about 15 miles away so we have provided our GPS coordinates so that you can make sure you have the correct address. Driving directions are provided below.

1.2: Phone Numbers: Main Office (Reception)

516-299-2752

Main Fax

516-299-2520

Thomas A. Pascarella, Dir. of Facilities/Production

516-299-2202

Production Manager

516-299-3349

Front of House Ops Manager

516-299-3193

Box Office Ticket Line

516-299-3100

LIU Post

516-299-3000

Public Safety **EMERGENCY**

516-299-2222

Old Brookville Police Dept.

516-676-1300

Roslyn Fire Department

516-621-7539

Poison Control

516-542-2323

North Shore University Hospital

516-562-0100

When ON CAMPUS, phone numbers with a 299- prefix can be directly dialed from any campus phone by just dialing the four digit extension. To make off campus calls from within campus, dial 9 and the number, For Long Distance, dial 9 plus 1 plus the area code then the number. Companies using the Tilles Center phone system may be assessed a charge for excessive usage and all long distance charges.

ALL EMERGENCIES

DIAL

X2222

1.2 KEY TILLES CENTER STAFF

ADMINISTRATION

Executive Director

Tom Dunn

Director of Facilities And Production Services

Thomas A. Pascarella

Director of Business Operations

Michaela Bowne

PRODUCTION STAFF

Production Manager

John Lant

AUDIENCE SERVICES

Operations (House) Manager

James Montefusco

Ticketing and Audience Services Manager

Michael Johnson

MARKETING

Director of Marketing

Shari Linker

Assistant Director of Marketing

Vanessa A. Kellogg

ARTS EDUCATION

Director of Arts Education

Stephanie Turner

Arts & Education Coordinator

Megan Montemurro

ADVANCEMENT

Director of Advancement

Shannon Preston

1.3 Campus Directions & Map

Directions to Tilles Center, located on the LIU Post Campus.

GPS Coordinates: [40.817096, -73.597691](#)

The LIU Post Campus of Long Island University is located on Northern Boulevard (Route 25A) in Brookville (Nassau County), New York.

NOTE – Once on campus, follow directions on attached Campus map!!

From New York City

Take Queens-Midtown Tunnel to Long Island Expressway (I-495). **Take Exit 39** and make a left at the light (Glen Cove Road north). Go north for 2 miles (3.2km); turn right (east) on Northern Boulevard (Route 25A). LIU Post is 2 miles on the right.

From Bronx, Westchester and Points North

Take the Throgs Neck Bridge to Clearview Expressway (I-295) south. Exit to eastbound Long Island Expressway (I-495); proceed to Exit 39 and continue as indicated above.

From Southern New Jersey and Points South

Take the New Jersey Turnpike to Exit 13. Cross the Goethals Bridge to I-278 east (Staten Island Expressway). Cross the Verrazano Narrows Bridge to the Belt Parkway east. Follow the Belt parkway to the Cross Island Parkway north (toward the Whitestone Bridge). Follow the Cross Island Parkway to Exit 30 - Long Island Expressway (I-495) east. Take the Long Island Expressway **to Exit 39**, and make a left at the light (Glen Cove Road north). Go north for 2 miles (3.2km); turn right (east) on Northern Boulevard (Route 25A). LIU Post is 2 miles on the right.

From Northern New Jersey

Take the George Washington Bridge east to the Cross Bronx Expressway. Cross the Throgs Neck Bridge then follow directions given from Bronx, Westchester and Points North.

From Eastern Long Island

Take Long Island Expressway (I-495) to Exit 41N (Route 106/107). Turn right (north) onto 106/107 north. Road will fork, follow Route 107 North (left fork). Proceed to Northern Boulevard (Route 25A). Turn left (west) at Northern Boulevard. LIU Post is on the left. Use second entrance into campus (West Gate) for quickest route to Tilles Center.

From South Shore of Long Island

In Nassau County, take the Wantagh State Parkway or Meadowbrook Parkway north to Northern State Parkway West to Exit 31 (Glen Cove Road North). At the light, turn left (north) onto Glen Cove Road. Proceed for 3 miles (4.8km) to Northern Boulevard (Route 25A), turn right (east). LIU Post is 2 miles (3.2km) on the right. In Suffolk County, take most convenient north-south road to the Long Island Expressway (I-495) and follow directions given from Eastern Long Island.

TillesCenter

for the Performing Arts LIU Post



Turn into the campus at the WEST Gate and continue immediately to your right, down Post Lane. Continue through the 1st stop sign. 500 feet past the stop sign, make your 1st available Left, after 'Kahn Discovery Center'. (See next page)



This Access Roadway will take you past the Front of House of Tilles (a large glass atrium on your right). At the end of the Access Road, behind a row of tall bushes will be the Tilles Center Loading Dock and Stage Door.

TILLES CENTER for the Performing Arts
 Long Island University / C.W. Post Campus
 720 Northern Boulevard
 Brookville, N.Y. 11548

NOTE: Acoustical Shell no longer in existence.

SECTION:

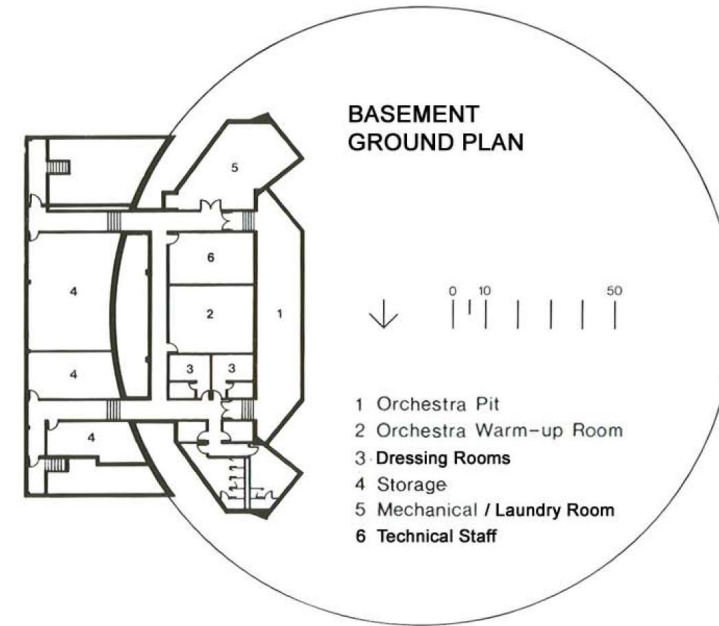
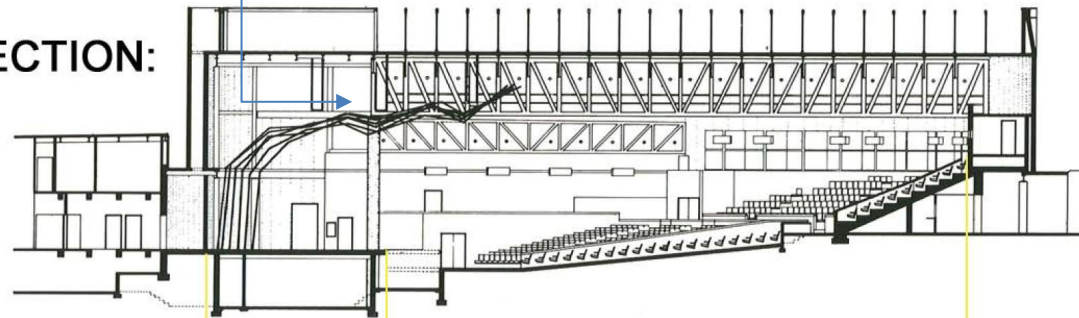

GROUND PLAN:

- A Green Room
- B Star Dressing Rooms
- C Chorus Dressing Rooms
- D Loading Dock Access
- E Showers
- F Toilets
- G Power Tie-in
- H Company Office
- J TC Technical Staff

- 1 Backstage
- 2 Stage
- 3 Pit and Stage Lift
- 4 Sloped Seating
- 5 Tiered Seating
- 6 Lobby

NOTE:
 Shaded area shows acting
 space on stage used for
 Proscenium configuration.
 Approximate 40' opening.

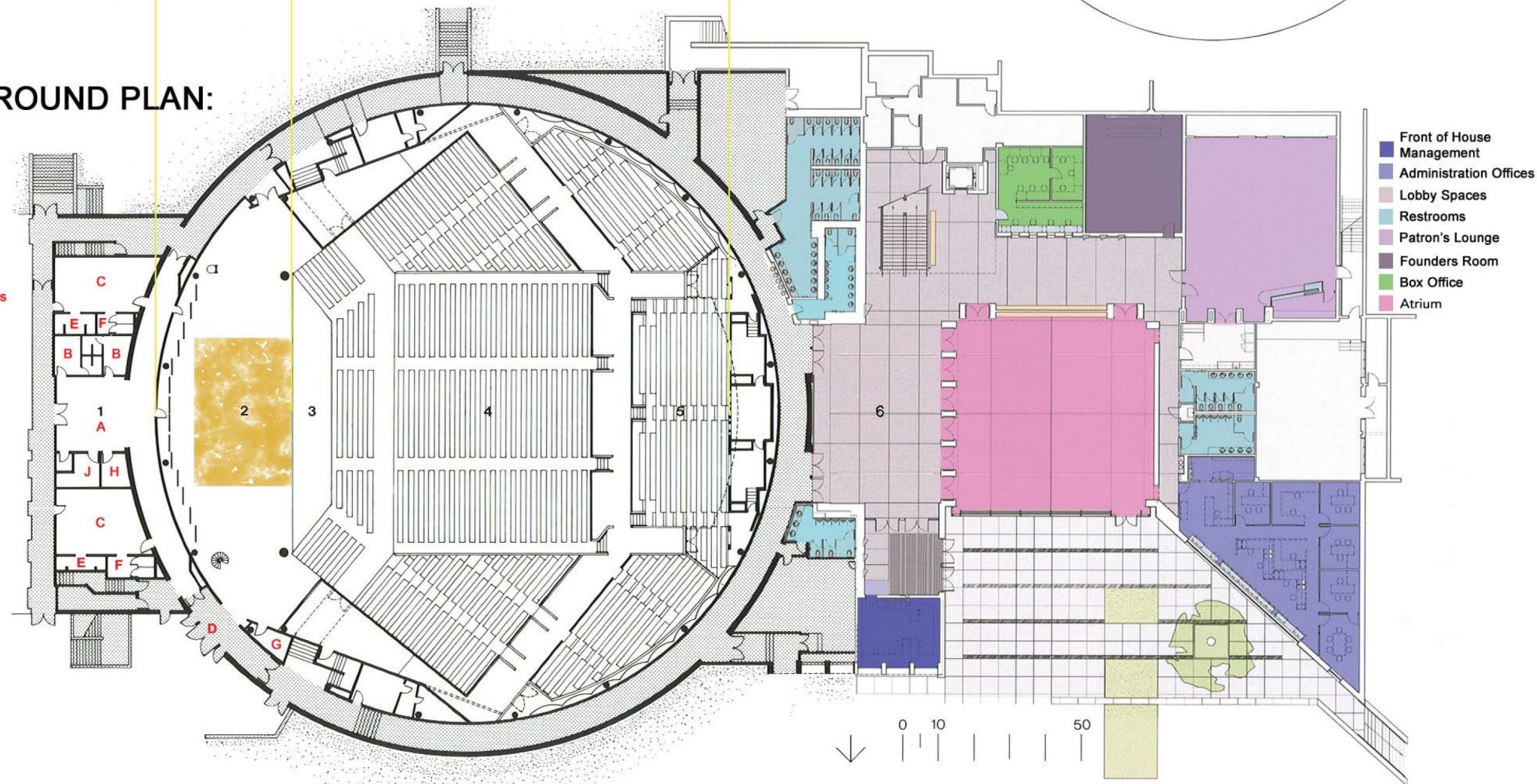

2.0 MAINSTAGE CONFIGURATIONS & CAPACITY FACTORS:

The Tilles Mainstage can take on many “personalities”. There are 2 basic configurations which impact performance type, sightlines, acoustics, and lighting. The stage’s natural home is “***Open Concert Shell***”. This configuration has no drapes, and has the full stage space available. The second configuration is “***Proscenium***”, where the stage is setup like a typical proscenium with a main portal and 4 sets of legs and borders with a full upstage drape (cyc, scrim, or blackout) upstage. This configuration yields a 30’ (9.14m) deep stage and a variable width stage from 40’-48’ (12.2m-14.63m) wide. This configuration impacts sightlines and brings down the capacity from 2214 to as low as 1750 depending on the stage width.

The orchestra pit may be seated to gain another 110 seats, and you may lose seats if the sound mix position is in the house. Please discuss your specific needs with us to obtain an accurate configuration and capacity. Please note that if you require a configuration that must be changed over to or restored, the producer may incur a fee for setup and restore of the space. Hours and fees are dependent upon multiple factors and must be discussed in advance.

BLUEPRINTS & PLANS:

Multiple versions and configurations of our Ground Plans, Sections, Projections, and Seating Charts etc. are available in pdf as well as their native formats (Word, Excel). All Tilles Center prints are drawn in Vectorworks, and all Lighting Paperwork is done in Lightwright. Please contact us if you require these files, as well as information on our version numbers and abilities to convert to other formats.

PDF Copies of all our ***Ground Plans*** and ***Seat Charts*** are available at the end of this document.

2.1 GENERAL BACKSTAGE INFORMATION

Stage and street at same height. A SHORT 14' (4.27m) ramp is available, the ramp is 39 ¾" Wide and has a side rail that is 2 ¼" Tall.

Loading door dimensions 9'-6" (2.9m) high x 9'-6" (2.9m) wide.

Our Dock is shaped like a comma, and can be tricky. Please discuss your needs with us. There is *some* room to leave trucks or vehicles. Alternate Parking is available a short walk from the theatre in the Campus "Gold" and "Green" Lots, refer to maps and pictures in section 1.3.

LOADING DOCK:



CONCERT STAGE:

70' wide x 30' deep on center line. Rear wall is curved. Permanent orchestra shell with moveable shells to adjust stage width. The stage deck is blonde maple wood.

PROSCENIUM STAGE:

40'-48' wide x 20' (6.1m) high soft proscenium. DS edge to last line set 26'-11". Entire stage is wood and fully sprung for dance. A Black LONSTAGE Marley dance floor available. An \$80 fee is charged for use of the Marley Dance Floor.

ORCHESTRA PIT:

60' (18.2m) wide x 11' (3.3m) deep. Travels from stage height to -8'. Stand lights and plug-in boxes available.

ORCHESTRA EQUIPMENT:

- (120) black armless musicians chairs
- Main Cond. Podium w/Rails (14" High)
- Cello Box
- (60) Incandescent Music Stand Lights
- 93 'Manhasset' Music Stands
- Large/Wide Conductors Music Stand
- Small Conductor Booster Box
- Assorted Stools

PIANOS:

Mainstage: (1) 9 foot Steinway Concert Model D Piano with padded artist's bench
Krasnoff Theater: (1) 7 foot Steinway Model D Piano with padded artist's bench
Atrium: (1) 5'10" Steinway Designed Boston GP-178 Piano with padded artist's bench
 All Pianos Tuned to A-440. Space and Physics prevent us Pianos from being moved between spaces.
 Piano tuning may only be done by Tilles Center staff tuner (charges apply).

RISERS:

Tilles Center has only ONE Riser. It is a 6' x 6' (1.8m²) Square Folding 'Drum' Riser. Please discuss your riser needs in advance so that we may arrange a rental. Due to the size of the stage and lack of storage, we attempt to use risers in small quantities and only when necessary.

LADDERS & LIFTS:

14' (4.2m) A-frame, 12' (3.6m) A Frame, 10' (3m) A-frame, 8' (2.4m) A-frame
 Skyjack Single Man Lift (36')(11m), Skyjack Scissor Platform Lift (32')(9.7m)

2.1 GENERAL INFORMATION (cont.)

COMPANY OFFICE:

Located backstage with desk and refrigerator.
High Speed Internet Access (LAN and Wireless Available).

INTERNET:

Guest Wireless is available by logging into "LIUNET-Guest". When the splash/login screen appears, you can register for an account and sign in. Accounts are good until 2am the following day. (2) High Speed Open and Clear Internet Lines from (2) separate ISPs are available for streaming events. Advance notice required. Although there are plenty of wired and wireless internet availability, the LIU infrastructure does not support enough bandwidth for an entire audience to be online at once.

CREW:

Our crew is very helpful and knowledgeable, and we all want to help you create a successful production. Tilles Center utilizes Professional Freelance, Student trainees, and Union Labor (when required) to staff all of our shows. All shows require at least (3) Crew; Lighting, Audio, and a Stage Manager, minimum. This, and any additional crew (requested, or determined to be needed by the Production Department, are billed separately, and is not included in your license fee. Tilles Center has access to professional Hair, Make-up, Followspot, Lighting Programmers, Audio Engineers, etc. to help produce your event. Please discuss your specific needs with the Production Manager, and we can work out a plan that meets your needs and your budget.

RENTALS:

Tilles Center can typically help secure all of your rental needs from our network of local third party vendors. Please call us to discuss.

RIGGING:

Rigging at Tilles Center poses many challenges. We highly recommend a site visit to determine your needs. If a site visit is not possible, please contact the Production Department to discuss the space and for additional pictures and drawings. Only Tilles staff and qualified personnel may rig in the space.

OBSTACLES:

The Acoustic Shell at Tilles Center does retract in most areas. There is a break that reveals the cove fixtures, as well as a downstage bay that houses linesets 1-4, and an upstage bay that opens and reveals the projection screen and linesets 5-12. Between linesets 4 and 5 is a fixed part of the acoustical shell and catwalk that limit the height of the stage to about 28'. It is under this obstruction that our 2 trusses (Drape Truss and Electrics Truss) are hung to accommodate the need for linesets in that area. Please contact the Production Department for more information.

2.2 HOSPITALITY & DRESSING ROOMS

CATERING

Catering is typically handled by our in house campus caterer: Aramark Dining Services. Catering should be initiated with your Tilles Center Rep. All orders should be placed 3-4 weeks in advance.

LAUNDRY FACILITIES:

(2) Washer, (2) dryers, iron with ironing board, and steamers are available.

DRESSING ROOMS:

Main Floor:	North Chorus Dressing Room (102)	18-20 people
	South Chorus Dressing Room (110)	16-18 People
	*Star Dressing Room A (107)	1-2 People
	Star Dressing Room B (109)	1-2 People
1 Flight Down:	Dressing Room A (009)	2-3 People
	Dressing Room B (008)	2-3 People
	**Warm Up Room C (010)	15-20 People

GROUND PLAN:

- A Green Room
- B Star Dressing Rooms
- C Chorus Dressing Rooms
- D Loading Dock Access
- E Showers
- F Toilets
- G Power Tie-in
- H Company Office
- J TC Technical Staff

- 1 Backstage
- 2 Stage
- 3 Pit and Stage Lift
- 4 Sloped Seating
- 5 Tiered Seating
- 6 Lobby

NOTE:
Shaded area shows acting space on stage used for Proscenium configuration. Approximate 40' opening.

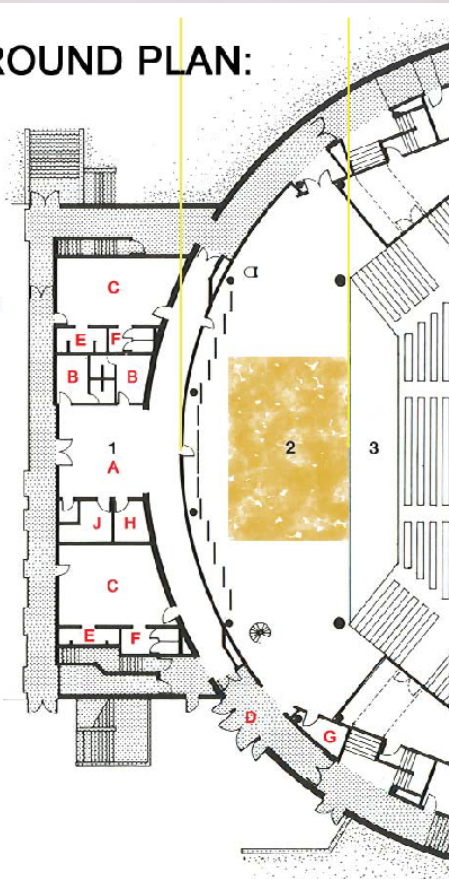

*ADA Accessible Bathroom Attached

**The Warm Up Room is typically reserved for catering and the room has no permanent mirrors. It is basically an empty room with some tables and chairs.

All Dressing Rooms have attached Showers with the exception of Star Dressing Room A (107) which *only* has a handicapped accessible toilet and sink.

2.3 FRONT OF HOUSE

FRONT OF HOUSE:	<p>Please make sure to discuss and furnish the following items to our Production and Front of House department prior to your arrival:</p> <ul style="list-style-type: none"> • Number of Intermissions/Pauses • Merchandise and Concessions • Approximate Timing of Event and parts • Late Seating Policy • Special Requests/Events at Intermission, Pre Show, or Post Show • House Open Time <p>Typically we prefer to open the house <u>60 minutes</u> prior to curtain. Please alert us if you need an alternate house open time.</p>
MERCHANDISE:	<p>Please call our FOH Ops Manager to discuss all commissions and fees. All merchandise is subject to an additional 8.625% sales tax. All taxes and commissions are due upon settlement at the end of the event. All Merchandise is handled through our FOH Manager.</p>
AUXILIARY EVENTS	<p>If you have and Pre Show, Post Show, or Intermission events, please make us aware so that we may plan accordingly and allocate and offer any resources we have available. Requests for tables, chairs, cloths, skirts and the like should be discussed with us at least 2 weeks in advance of your event.</p>
SECURITY	<p>Campus Public safety is engaged at Tilles Center for every event. If you require additional security, or have concerns please speak to us in advance of your event. All security or safety personnel must be approved in advance by our public safety department.</p>
CONTACT	<p style="text-align: center;">Our Front of House Manager can be reached at: 516-299-3193</p>

3.0 RIGGING MEASUREMENTS GUIDE

33'6 ½"	10.2m	Max Out position – Pipe #1
34'8"	10.5m	Max Out position – Pipe #5
35'0"	10.6m	Max Out position – Pipes #2-12 (average height)
26'0"	7.9m	Max Out position – Trusses
34' ½"	10.5m	Pipe #1 sheave beam to stage floor
37'10 ½"	11.5m	Hemp sheave channel to stage floor
38'4 ½"	11.7m	Standard sheave channel to stage floor
29'6 ½"	9.0m	Catwalk bottom C-beam (4") to stage floor
33'4 ½"	10.1m	Catwalk top rail to stage floor
3'6"	1.1m	Catwalk top rail to catwalk floor
42' ¾"	12.8m	Ceiling to Floor
40'3 ½"	12.3m	Major I-Beam (up/downstage) to floor
38'8 ½"	11.8m	Upstage cross-stage junior beam to stage floor
36' ¾"	10.9m	Lowest structural truss beam to stage floor
6'0"	1.8m	Height of ceiling truss top to bottom

3.1 STAGE RIGGING LINESET SCHEDULE

(FULL PAGE Lineset Worksheet available in the Appendix)

SET	DISTANCE ₁	TYPE	MAX OUT	STANDARD USAGE
1	2'8" (0.81m)	Winch ₂	33'-6 1/2" (10.23m)	#1 Legs & Border ₃ . Opening 40'-45'. Trim 20' ₅
2	3'10" (1.16m)	Winch ₂	35'-0" (10.66m)	Act Curtain ₃ . Traveler. Manual Black Velour
3	5'5" (1.65m)	Winch ₂	35'-0" (10.66m)	#1 Electric
4	6'5" (1.96m)	Winch ₂	35'-0" (10.66m)	Spare
DS Truss	9'6" (2.90m)	Hoist ₄	26'-0" (7.92m)	#2 Legs & Border ₃ . Border Trims @ 20'6" ₅
US Truss	11'10" (3.61m)	Hoist ₄	26'-0" (7.92m)	#2 Electric
5	17'5" (5.31m)	Winch ₂	34'-8" (10.55m)	#3 Legs & Border ₃ . Border Trims @ 22'0" ₅
6	19'5" (5.92m)	Winch ₂	35'-0" (10.66m)	#3 Electric
7	21'2" (6.45m)	Winch ₂	35'-0" (10.66m)	Spare
8	22'3" (6.78m)	Winch ₂	35'-0" (10.66m)	#4 Legs & Border ₃ . Border Trims @ 22'0" ₅
9	24'0" (7.32m)	Winch ₂	35'-0" (10.66m)	#4 Electric
10	25'8" (7.82m)	Winch ₂	35'-0" (10.66m)	#5 Electric
11	26'8" (8.13m)	Winch ₂	35'-0" (10.66m)	Spare
12	26'11" (8.50m)	Winch ₂	35'-0" (10.66m)	Black Backdrop or Cyc

NOTES

- Distances are from the downstage edge of stage proper (Plasterline)
- Winch sets are driven by line shaft motors. Maximum trim height is 35'0" (10.66m).
All battens are 1 1/2" (.038m) x 60'0" (18.28m) schedule 40 pipe
- Main act curtain and Leg & Border sets are heavyweight black velour
- Each set is of three 1/2 ton CM Chain Hoists with 1'0" triangular truss (Drapes) & 1'0" Box Truss (LX)
- Trim heights of Leg & Border sets are their maximum high trim.

3.2 MAINSTAGE SOFT GOODS

As of the 2016-17 season, All drapery is 25 oz., memorable, charisma synthetic IFR black velour, sewn flat with chain pocket at bottom and webbing, grommets and ties at top, unless otherwise noted. Typical Rep Hang consists of 4 sets of Legs and Border creating 4 wings.

Our 28' (8.5m) Legs, and 8' (2.4m) Tall Borders combine on the same lineset to create a 20' (6.1m) High opening. The minimum width is 42' (12.8m) with a maximum of 48' (14.6m).

Qty.	TYPE	REP. HANG POS.	SIZE
2	Main Drape	#2 Pipe	30'0" W x 30'0" H each (9.14m x 9.14m)
2	#1 Legs	#1 Pipe	12' wide x 28' high (3.66m x 8.53m)
1	#1 Border	#1 Pipe	60' wide x 8' high (18.29m x 2.34m)
2	#2 Legs	Drapery Truss	16'-6" wide x 25' high (5.03m x 7.62m)
1	#2 Border	Drapery Truss	64' wide x 4'-6" high (19.50m x 1.37m)
2	#3 Legs	#5 Pipe	12' wide x 30' high (3.65m x 9.14m)
1	#3 Border	#5 Pipe	60' wide x 8' high (18.29m x 2.44m)
2	#4 Legs	#8 Pipe	12' wide x 30' high (3.65m x 9.14m)
1	#4 Border	#8 Pipe	60' wide x 8' high (18.29m x 2.44m)
1	Cyc, white seamless muslin	#12 Pipe	60' wide x 30' high (18.29m x 9.14m)
1	Scrim, black sharktooth		60' wide x 28' high (18.29m x 8.53m)
1	Scrim, pale blue sharktooth		60' wide x 27'-6" high (18.29m x 1.83m)

RCP & LINESET SCHEDULE WORKSHEETS IN DOCUMENT APPENDIX

3.4 TILLES DIMENSIONS QUICK LIST

Concert Shell - Open Stage

34'-9"	Depth on center line	10.59m
27'-2"	Depth @ offstage edges	8.28m
72'-2"	Width of stage, column to column	21.99m
23'-0"	Wing space left & right	7.00m
3'-8"	Stage to floor of house	1.11m
26'-6"	Height of main columns	8.07m

Orchestra Pit

(The orchestra pit is trapezoidal in shape, with the wide end upstage)

77'-6"	Width, upstage edge	23.62m
51'-4"	Width, downstage edge	15.64m
10'-10"	Depth	3.29m
0'-0"	High Trim: Stage level	0.00m
-3'-8"	House Level Trim: Below Stage Level	1.09m
-8'-1"	Low/True Pit Trim: Below Stage Level	2.46m

Proscenium/Dance Stage

34'-9"	Stage edge to back wall on center line	10.59m
27'-2 ½"	Stage edge to last line set (#12)	8.28m
42' - 48'	Proscenium opening	12.80m-14.63m
20'-0"	Proscenium height	6.10m
35'-2"	Floor to pipe high trim	10.72m
33' (varies)	Offstage wing to side wall	10.06m

Miscellaneous

144'-0"	Projection booth to movie screen	43.89m
36'-6"	Projection booth to house mix position	11.13m
86'-11"	House mix position to stage edge on center line	26.49m
104'-0"	House mix position to movie screen	31.70m
70'-0"	Center line to company switch on SR	21.34m
68'-0"	Followspot to stage edge (Appx 30° Angle)	20.73m
9'-6"	Loading doors height	2.90m
9'-6"	Loading doors width	2.90m
87'-8"	Radius of theatre interior	26.72m

4.0 LIGHTING, ELECTRICS, & EFFECTS

<u>LIGHTING SYSTEM:</u>	<p>Tilles Center Mainstage has 192 Strand CD80 Dimmers at 2.4kW each. They run through permanently distributed house circuits around the theater. The Theater operates on DMX, and has tie-ins at the appropriate places.</p> <p style="padding-left: 40px;">Universe (A): Theatrical Dimmers [1-192] +Intels Universe (B): Intels Universe (C): House Light Dimmers [1-96]</p> <p>There is (1) 5 port opto-splitter available and limited supplies of DMX</p>
<u>LIGHTING CONSOLES:</u>	<ul style="list-style-type: none"> ●Strand Palette VL64 ●ETC Express 24/48 ●ETC Expression 3 ●ETC ION XE20
<u>FOLLOWSPOTS:</u>	<p>(2) Xenon Super Trouper 1.6kW Located Over the Center of the House Spots cannot generally reach into the house much. The spots shoot the stage at about a 30° Angle @ 6' (1.83m) High at DSC.</p>
<u>BOOMS:</u>	<p>(6) 12' (3.66m) Traditional Lighting Booms w/ 50# Bases Rep Booms consist of a Head, Mid, & Shin on each of 3 Booms per side with a total of 18 circuits available.</p>
<u>COMPANY SWITCH:</u>	<p>Located stage right approximately 110' from Centerline.</p> <ul style="list-style-type: none"> (1) 800 AMP Cam Lok Lighting Disconnect (1) 200 AMP Cam Lok Audio Disconnect
<u>ATMOSPHERICS & EFFECTS:</u>	<p>The use of any atmospheric effects (Smoke, Haze, Fog) require an alteration of the fire alarm system. The system must be altered at all rehearsals and performances that the effects will be used. Additionally, an appropriate Fire Watch (usually 1-3 Firemen) are required in the building when the alarms are altered and an audience is present. These mandates come from our campus, town, county and state fire marshals. Costs associated with the fire watch and system alterations will be charged to the producer. Please contact us for fees and estimates.</p>
<u>LIGHTING CHALLENGES:</u>	<p>The Followspots can only spot into the first 3-4 rows of fixed seating in the House. Lighting the Orchestra Pit in Proscenium or Jazz configuration is typically a challenge due to the lack of positions available to light the pit from the top, sides, and back. Please discuss your Orchestra Pit Lighting needs with us in advance.</p>

6 weeks advance notice is required of all shows planning on using atmospheric and effects. Please contact the Technical Director for fees and scheduling.

4.0 LIGHTING, ELECTRICS, & EFFECTS (cont.)

HOUSE/WORK LIGHTS:

House lights are on a totally separate dimming system controlled by an ETC Unison Architectural Dimming System. There is an LCD and Fader panel stage right as well as a fader panel in the lighting booth. There is an interface point in both the booth and stage right to input into this system via DMX512 and any standard lighting console. Work light is provided by flood fixtures over the stage and wings controlled only by switches stage right.

AISLE LIGHTS:

In seat aisle lights are required to be on at every performance as per Fire and Safety Regulations and can only be controlled by a local switch off stage right.

CONCERT LIGHTING SYSTEM:

The Concert System stage wash creates an even white light wash across the stage and pit and is dimmable. The system consists of Source Four ERS's, Source Four Pars, and Source Four PARnels on a totally separate dimming system controlled by an ETC Unison Architectural Dimming System. This system was installed in September of 2001 along with our new House Light System that provides more than adequate light on stage for white light events. This system was specifically designed to meet the needs and limitations of lighting the world's most prestigious orchestras. Generally, only certain specials in this system can be re-focused or gelled.

REP PLOT:

This plot consists of a 4 color front wash, 4 color over-stage wash, 2 color back wash, pipe-ends, specials, and the normal compliment of FOH positions. Tilles Center does not guarantee that this suggested plot will always be available as drawn without setup, nor is it meant to discourage companies from specifying their own plot. For maximum efficiency, companies should carefully review the enclosed information and submit a detailed plot, hookup and color list to Tilles Center technical staff at least six weeks in advance of the performance date. Provisions should be included for us to contact the company's lighting representative to answer any questions we may have with the setup.

DESIGN NOTES:

The following suggestions are offered to designers and electricians towards achieving an efficient and successful setup in our theater:
The instrumentation shown on the house plot represents our recommendations for the best use of our equipment for a standard plot. In general, plots which follow this basic outline will require a minimum of setup time. We tend to run short of circuits upstage of the first electric pipe and on the booms. Please try to two-fer as much as possible in this area in order to save on long and complex cable runs.
If you would like to utilize our stock of color media, please specify Roscolux, as that is what we have most of. We will prepare as much as possible from our stock of cut color; the balance will be purchased, charged to the producer, and will remain in our stock at the end of the run. If you provide all the color, you may of course take it with you when you leave

PDF Copy of our Repertory Light Plot is included at the end of this document.
Copies of the "Rep" Instrument Schedule and Channel Hookup are available upon request.

4.1 LIGHTING INVENTORY

Front of House: These units are permanently hung in FOH rep.

Qty	Instrument/Size	Wattage	Lamp	Frame	Gobo	Perm Rep. Pos.
6	5° Altman Ellipsoidal	1000	FEL	12" x 12"	B	Booth Rail
8	10° Source IV Ellipsoidal	575	HPL	12" x 12"	B	Followspot Platform
20	14° Source IV Ellipsoidal	575	HPL	7.5" x 7.5"	B	Box Booms L+R
8	15°-35° Altman Shakespeare Zoom	575	HX600	7.5" x 7.5"	B	Box Booms L+R
25	19° Source IV Ellipsoidal	575	HPL	7.5" x 7.5"	B	Cove

The remainder of the inventory is available to move if the rep plot is not desired:

Qty	Instrument/Size	Wattage	Lamp	Frame	Gobo	Notes
3	19° Source IV Ellipsoidal	575	HPL	6" x 6"	B	Barrels Only
30	26° Source IV Ellipsoidal	575	HPL	6" x 6"	B	
40	36° Source IV Ellipsoidal	575	HPL	6" x 6"	B	+8 Barrels
6	50° Source IV Ellipsoidal	575	HPL	6" x 6"	B	
8	Altman Axial 6x9 (36°)	575	FLK	7.5" x 7.5"	B	
36	Altman PAR64	1000	FF_	10" x 10"	N/A	WFL, MFL, NSP, VNSP
32	Source IV Par	575	HPL	7.5" x 7.5"	N/A	WFL, MFL, NSP, VNSP
4	6" Fresnel	500	BTL	7.5" x 7.5"	N/A	
8	8" Fresnel	1000	BTR	10" x 10"	N/A	
8	Martin MAC AURA (11°-58°)	260	LED	N/A	N/A	P,T,Z,RGBA
12	Martin MAC AURA XBs (10°-60°)	400	LED	N/A	N/A	P,T,Z, RGBA
7	Martin MAC ENCORE Performance CLD (12°-48°)	596	LED	N/A	Yes	P,T,Z,I,CW,GW,AD, Shutters, CYM
7	Berkley-Colortran 5'/6 cell/3 circuit Cyc Light	1000/cell	FHM	9" x 13"	N/A	

Accurate on date of printing. Contact us for to confirm accessories inventories (Top Hat, Iris, Barn Door, Gel Ext., etc.).

4.2 MISCELLANEOUS LIGHTING GAK INVENTORY

QTY	ITEM	NOTES
ALL	C-Clamps and Color Fames	1+ for each fixture in stock
18	Template Holders (B)	Strand Fixtures
20	Template Holders (B)	Altman Fixtures
12	Template Holders (B)	Skakespeare Fixtures
24	Template Holders (B)	ETC Fixtures
7	Template Holders (A)	ETC Fixtures
2	Iris	For ETC Fixtures
8	Tophats- 12"	
10	Tophats- 10"	
24	Tophats- 7 ½"	
12	Halfhats- 7 ½"	
18	Tophats- 6"	
12	Gel Extenders- 6"	
12	Gel Extenders- 7 ½"	
12	4 Leaf Barn Doors- 10"	
4	2 Leaf Barn Doors- 10"	
5	4 Leaf Barn Doors- 7 ½"	
14	Donuts- 6"	
32	Donuts- 7 ½"	
2	Castered 4' Rovers	
11	Sidearms- 18" Single Tee	
22	Sidearms- 12" Single Tee	

The above is only select inventory, and due to the nature of the business, the quantities of the above items can fluctuate wildly. Please discuss any needs you have with us in advance, and feel free to ask for anything we have not included above. Tilles Center has a sufficient inventory of lighting cable, Edison extension cords, two-fers, adapters, and etc.

5.0 SOUND SYSTEM

TILLES CENTER PREMIUM SOUND PACKAGE

In 2011, Tilles Center acquired a State of the Art Premium JBL Line Array Speaker System. This system is permanently installed in the Concert Hall and may be used at no additional fee. The system was specified, installed, and tuned to perfection by SK Systems of Bohemia, led by Tom Heinisch. The installed sound package provides access to the following permanently installed gear:

Speakers and Positions:

Mains Left and Right	(18) JBL Vertec 4888 Mid-Size Line Array Speakers, flown 9 per side
Subs Left and Right	(6) JBL Vertec 4880 2x18" Subwoofers, 3 per side in Cardioid Configuration on deck
Center Fill Cluster*	(3) JBL VRX932 Speakers flown at center
Front (Lip) Fill**	(5) JBL VRX 928 Speakers (adjustable for use on Stage or Orchestra Pit)

*If the Orchestra Pit is not seated, only (2) VRX932's are required.

**Use of Front Fill is at the discretion of the visiting company.

The System also includes all of the Amplifiers, Cabling, and Signal Processing to completely power and drive the system.

This additional equipment includes:

- (3) Lab Gruppen FP3400 Amplifiers
- (12) Lab Gruppen FP6400 Amplifiers
- (1) Lab Gruppen FP1000Q Amplifier
- XTA DP226 Loudspeaker Management System
- BSS Soundweb London BLU Signal Processors, Networking, and Output Expanders

MONITOR SYSTEM:

JBL System	(8) JBL SRX 812 12" & 1.5" Loaded Full Range Cabinets (Bi-Amped) With (8) Channels CrownXTi 4002 Power Amps (2x 1200W @ 4ohm)
Yamaha System	(6) Yamaha SM12IV 12" Monitors With (6) Channels of Crown XLS-402 Amps

Fees & Expenses:

You will be required to have one of our House Sound Technicians on call whenever the system will be in use. All Sound Equipment at Tilles Center is included for use in your License fee, however all equipment is subject to availability.

5.1 SOUND & SUPPORT INFORMATION

The following Tilles Inventory is available at no additional cost (pending availability):

ADDITIONAL SPEAKER INVENTORY:	(6) Meyer CQ1 (4) Meyer 650P
HOUSE CONSOLES AVAILABLE:	<i>Soundcraft Series Two 32 X 8 Mixing Console (Analog)</i> <i>Midas M32 (Digital)</i> <i>Midas M32R (Digital)</i>
INTERCOM SYSTEM:	2 Channel Clear-Com system available throughout the theatre. Wired Single Channel Boxes with Single or Double Muff Headsets available. 3 Wireless Packs and Headsets Available (Telex BTR700 System) There is also a paging system to all dressing rooms and backstage areas.
ASSISTED LISTENING SYSTEM:	The Theater uses a Listen Technologies FM Assisted Listening System. All events are required to broadcast their event on our Assisted Listening System.
PROGRAM DISTRIBUTION:	Any input into the Main Speaker System will automatically distribute program feed to backstage, Front Of House, Closed Circuit Video Monitor and our Assisted Listening System. If you choose not to use the House sound equipment, you are required to send the venue at least (1) Post Fade Mix for our distribution network.
MIX POSITION:	Sound Control can easily be achieved in 2 locations. The Sound Booth at the back of the house is approximately 125' (38.10m) from the stage. An Alternative Mix Position is located in the center of the house, Approximately 85' (25.91m) from plaster line. If this position is used, it will require us to kill Rows XX and YY Seats 121-130 with the Box Office
HOUSE SNAKE (BUILT IN):	In addition to the portable audio snakes in our inventory, Tilles Center has 16 permanently wired snake runs built into the theater. Lines 1-16 can be accessed from the Sound Booth, House Mix Position, Stage Right and Stage Left. Lines 9-16 can be accessed from a panel in the orchestra pit when the pit is at its low trim.
BACKLINE:	Tilles Center has a small selection of backline, please contact us for a current list and availability.

5.2 MICROPHONE INVENTORY

Qty.	Manufacturer	Microphone Type/Model
13	Shure	SM58
2	Shure	SM58 (Switched)
1	Shure	BETA 58
4	Shure	SM57
3	Shure	SM81
1	Shure	SM11
2	Shure	PG52
3	Shure	PG56
5	AKG	C414
7	AKG	C535-EB
2	AKG	D190
2	Sennheiser	MD 421
2	Sennheiser	MD 431
2	Electro Voice	RE20
3	Crown	PCC
2	Crown	PZM

5.2.1 WIRELESS MICROPHONE INVENTORY

4	Shure ULDX	Receivers (WIRELESS)
3	Shure ULDX	Dual Receivers (Wireless)
8	Shure ULXD1	Body Pack Transmitters
10	Shure ULXD2	Beta 87A Handheld Transmitters
8	Countryman B6	Lavaliere Mics (Beige)
2	Sennheiser	Evolution E100 (WIRELESS)

5.3 MICROPHONE ACCESSORIES

Qty.	Accessory
3	Gooseneck Extensions (8-12")
9	DI Boxes
2	PCDI (Whirlwind)
2	POD-DI (Whirlwind)
1	POD-MIX DI (Whirlwind)
3	Desktop Base
2	Black Straight/Round Base Mic Stand (Atlas)
4	Silver Straight/Round Base Mic Stand
3	Baby (Bass) Boom Stand
13	Traditional Boom Stands (Various Arm Lengths)
3	Hot Spot Nano Personal Monitors

5.4 ADDITIONAL PROCESSING & SOURCE EQUIPMENT

Qty.	Manufacturer	Item
1	Sony	Mini Disc Player MDS-E10
1	DENON	CD Player/Recorder
2	DENON DN-501C	CD/Media Player
5	Rane	ME60 1/3 Octave EQ (2 Channels)
1	Behringer	CX2310 Crossover
1	Alesis	Quadraverb Effects Processor
1	Yamaha	SPX990 Effects Processor
1	Alesis	3630 Compressor/Limiter
1	Whirlwind	150 foot 24/4 mic snake
1	Tilles	50 foot 6 channel mic snake

Tilles Center owns XLR, Speakon, Patch cable, and adapters to create a working system for small to medium size performances. Please discuss your needs in advance with the Technical Director to determine if any rental equipment will be needed to completely fulfill your event requirements.

5.5 SOUND ADVICE

(from Robert Goida Director of Facilities, former Production Manager and Sound Guru, from 1981-2020)

Tilles Center is not a deep house. The distance from the stage to the back wall is only 150'. However, the house is wide. If you are bringing in your own sound keep this in mind. The in house sound system is hung and aimed to cover every seat in the house so you might want to consider using it.

Quick Tip to the Sound Guy

During the day when you do set up and sound check you may find that our venue sounds sharp. Do not remove all of this high end. When the theater is full that edge that you heard will be gone and you will spend the top of the show restoring some of what you removed. Tried and true advice, use as you see fit.

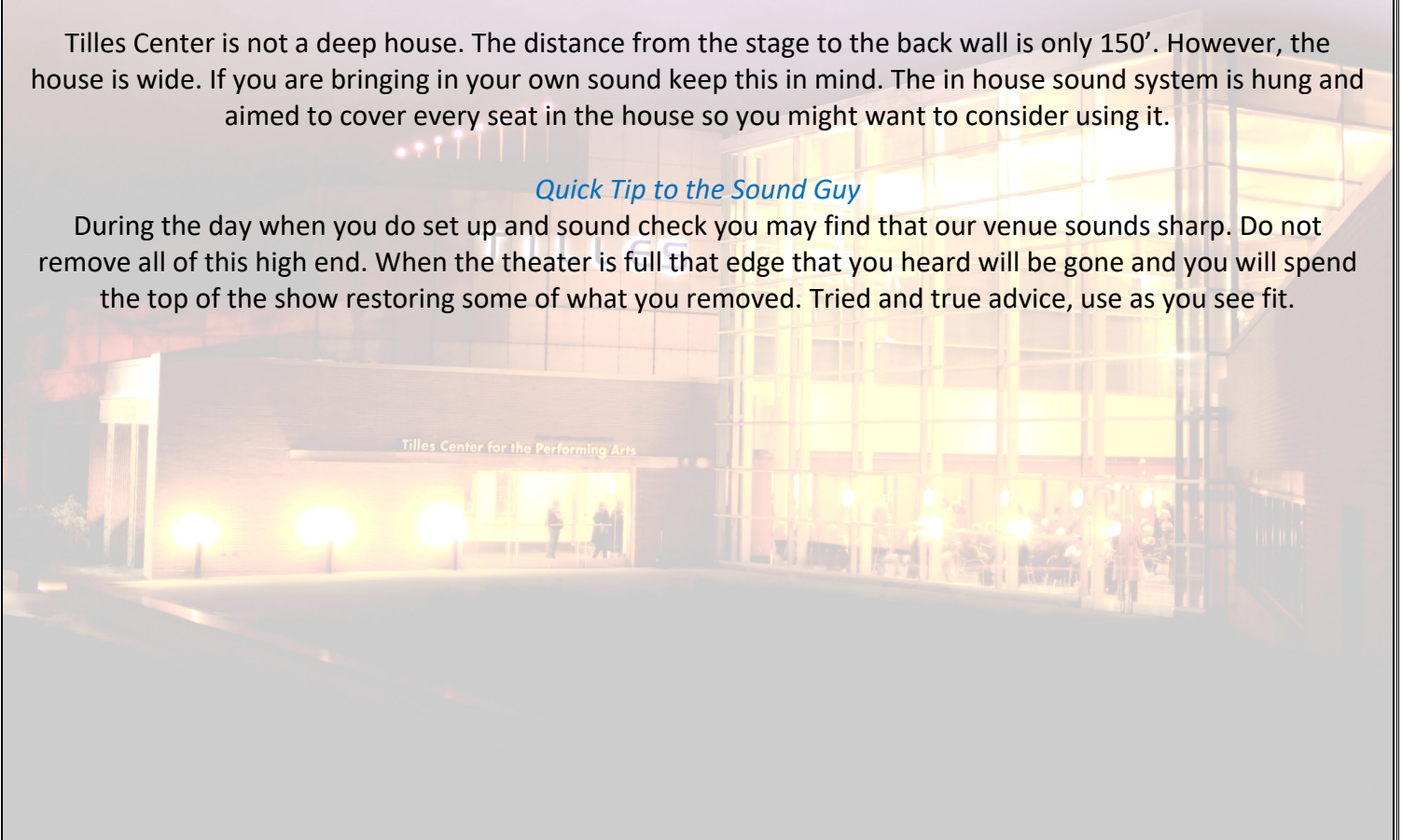

6.0 TILLES PROJECTION & VIDEO INFO

PROJECTOR:

MAKE/MODEL:	PANASONIC PT-DZ21K2U
LUMENS/BRIGHTNESS:	20,000 LUMENS (10K)
NATVE RESOLUTION:	1920x1200 (WUXGA)
CONTRAST RATIO:	10,000:1
ASPECT RATIOS:	16:9 and 4:3
LENS:	D75-LE4 (5.2-8.2:1 Zoom) D75-LE30 (2.4-4.7:1 Zoom)

6.1 MAINSTAGE SCREEN:

HEIGHT (VARIABLE):	1' - 20'
WIDTH (FIXED):	40'
DEPTH @ PLASTERLINE:	20'-6"

CYCLORAMA SURFACE:

HEIGHT (FIXED):	20'
WIDTH (VARIABLE):	19' - 50'
DEPTH @ PLASTERLINE:	26' - 11"

D75-LE4 (5.2-8.2:1 Zoom)	16:9 Min	16:9 Max	4:3 Min	4:3 Max
IMAGE HEIGHT	10'-8"	16'-7"	10'-8"	16'-4"
IMAGE WIDTH	19'-0"	29'-6"	14'-2"	21'-9"
IMAGE DIAGONAL	21'-8 ½"	33'-10"	17'-9"	27'-2"

D75-LE30 (2.4-4.7:1 Zoom)	16:9 Min	16:9 Max	4:3 Min	4:3 Max
IMAGE HEIGHT				
IMAGE WIDTH				
IMAGE DIAGONAL				

DIMENSIONS OF IMAGE BASED ON PROJECTING FROM BOOTH TO CYC

DISTANCE MEASUREMENTS

FROM/TO	PLASTERLINE	PROJ SCREEN	CYCLORAMA
PROJ BOOTH	124'	144'	151'
MIX POSITION	86'	106'	113'

Distances rounded to nearest foot

6.2 INPUT SOURCES:

BluRay Player-Panasonic BDT310	Blu-ray, DVD, VCD, SVCD, CD, YouTube, Skype, BR3D
DVD Player	DVD, CD
Laptop	MP4, MP3, AVI, WAV, MPG
Cable TV	Dish Network
VCR	VHS Tapes

SUPPORT EQUIPMENT:

Presentation Switcher/Scaler	Kramer VP-729 w/Assorted Inputs
Multi Format DA	Kramer VM-73 w/Assorted I/O (1:3)x4
HDMI over CAT5 Xmit/Rcv	Kramer

CAMERAS:

HD CAMERA CLOSED LOBBY FEED	Panasonic AG-HMC80
-----------------------------	--------------------

FEES: A \$50 fee applies for most rentals wishing to use the projection equipment, and a Video/projectionist is required to hire for all events utilizing the equipment.



APPENDIX A: VIDEO IMAGE SIZE DRAWINGS

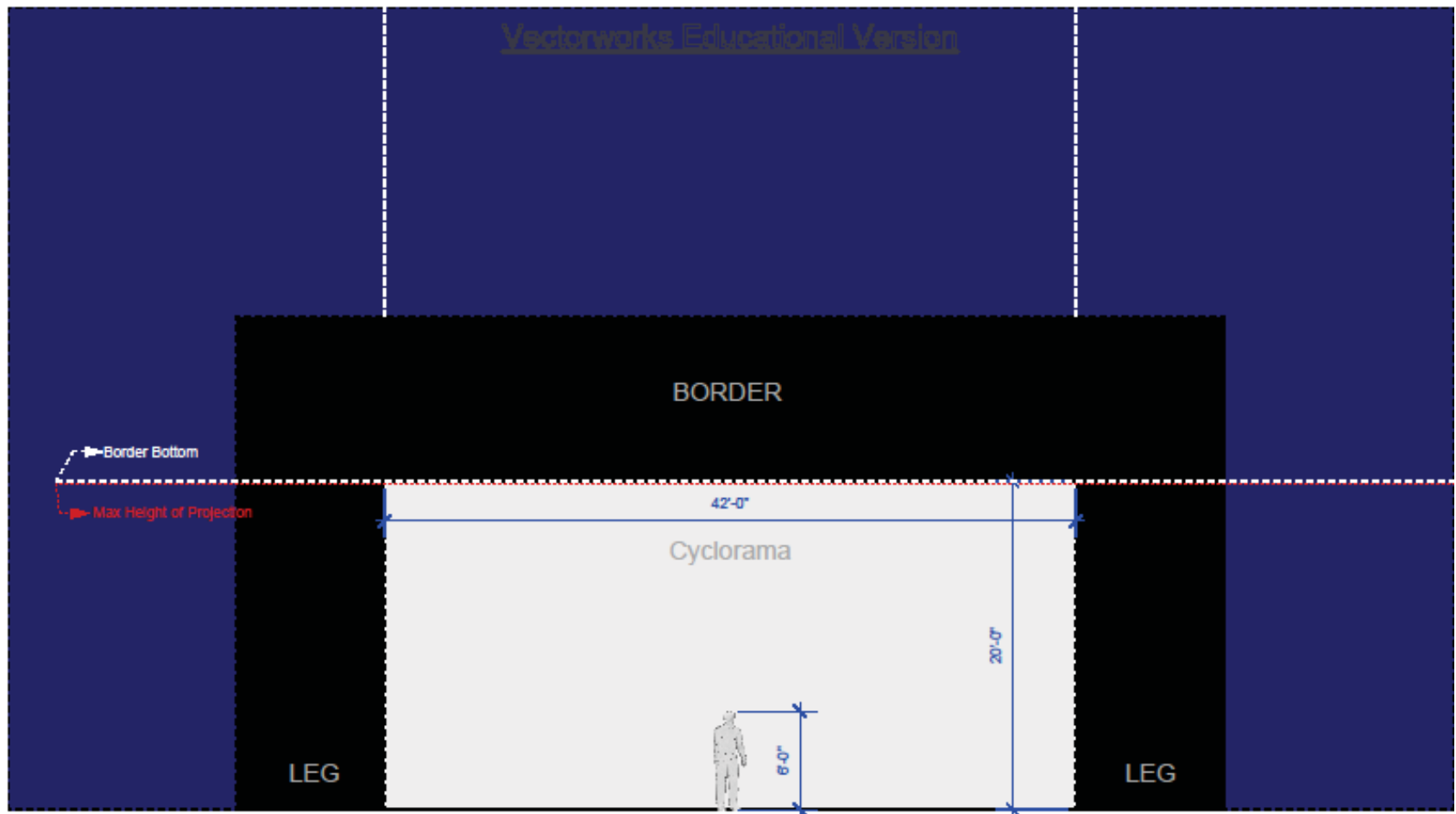

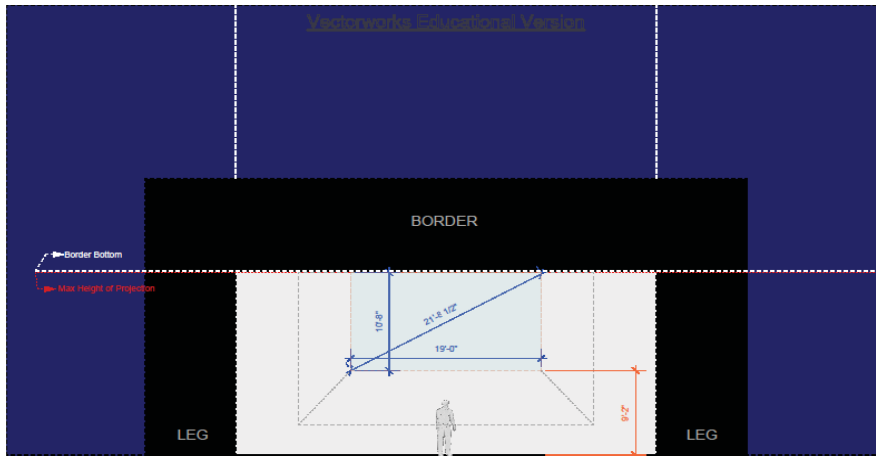

16:9 Zoom (5:2-1 to 8:2-1)

TillesCenter
for the Performing Arts LIU Post

VIDEO PROJECTION SIZE CHARTS—JAN 2013

Vectorworks Educational Version

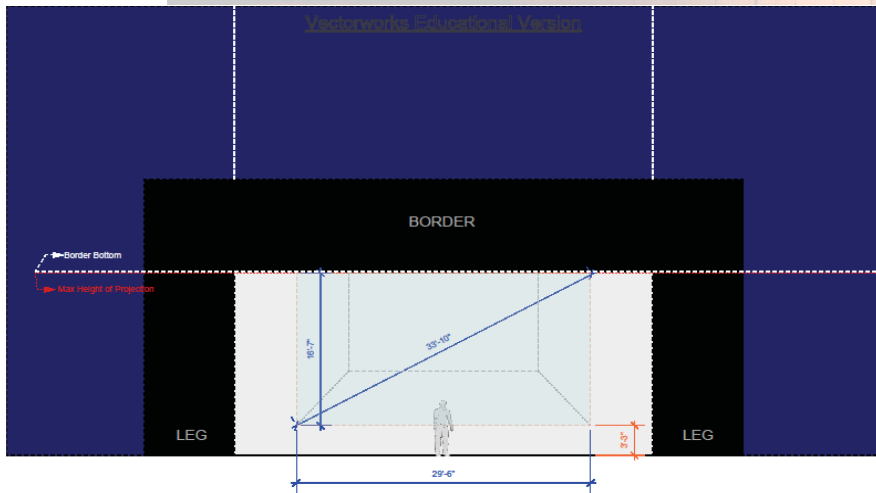

16:9 Zoom (5:2-1 to 8:2-1)

TillesCenter
for the Performing Arts LIU Post

VIDEO PROJECTION SIZE CHARTS—JAN 2013

Vectorworks Educational Version

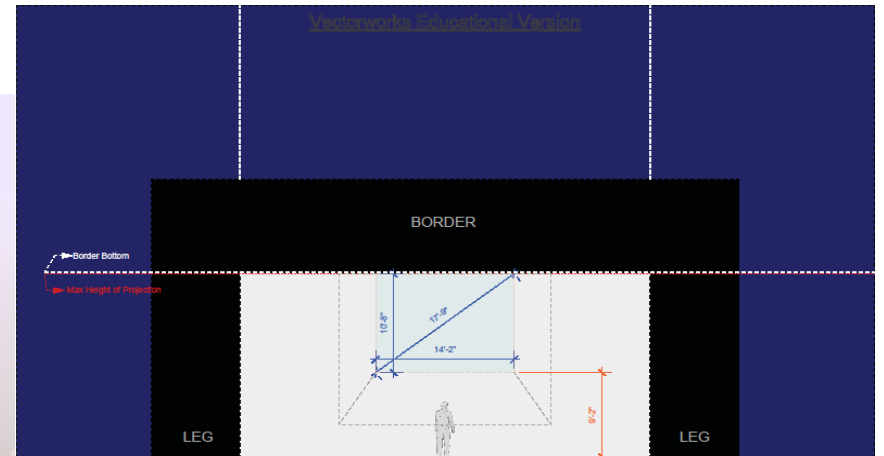

4:3 Zoom (5:2-1 to 8:2-1)

TillesCenter
for the Performing Arts LIU Post

VIDEO PROJECTION SIZE CHARTS—JAN 2013

Vectorworks Educational Version

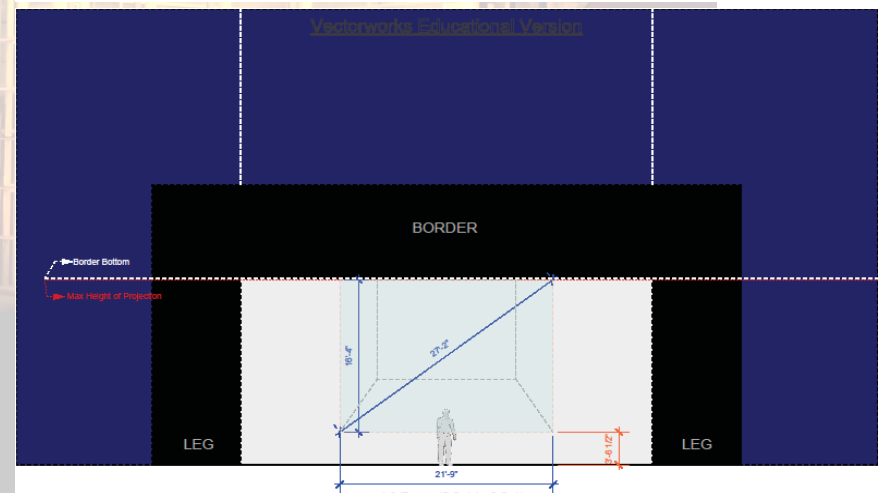

4:3 Zoom (5:2-1 to 8:2-1)

TillesCenter
for the Performing Arts LIU Post

VIDEO PROJECTION SIZE CHARTS—JAN 2013

Vectorworks Educational Version



APPENDIX B: GROUND PLANS

Vectorworks Educational Version

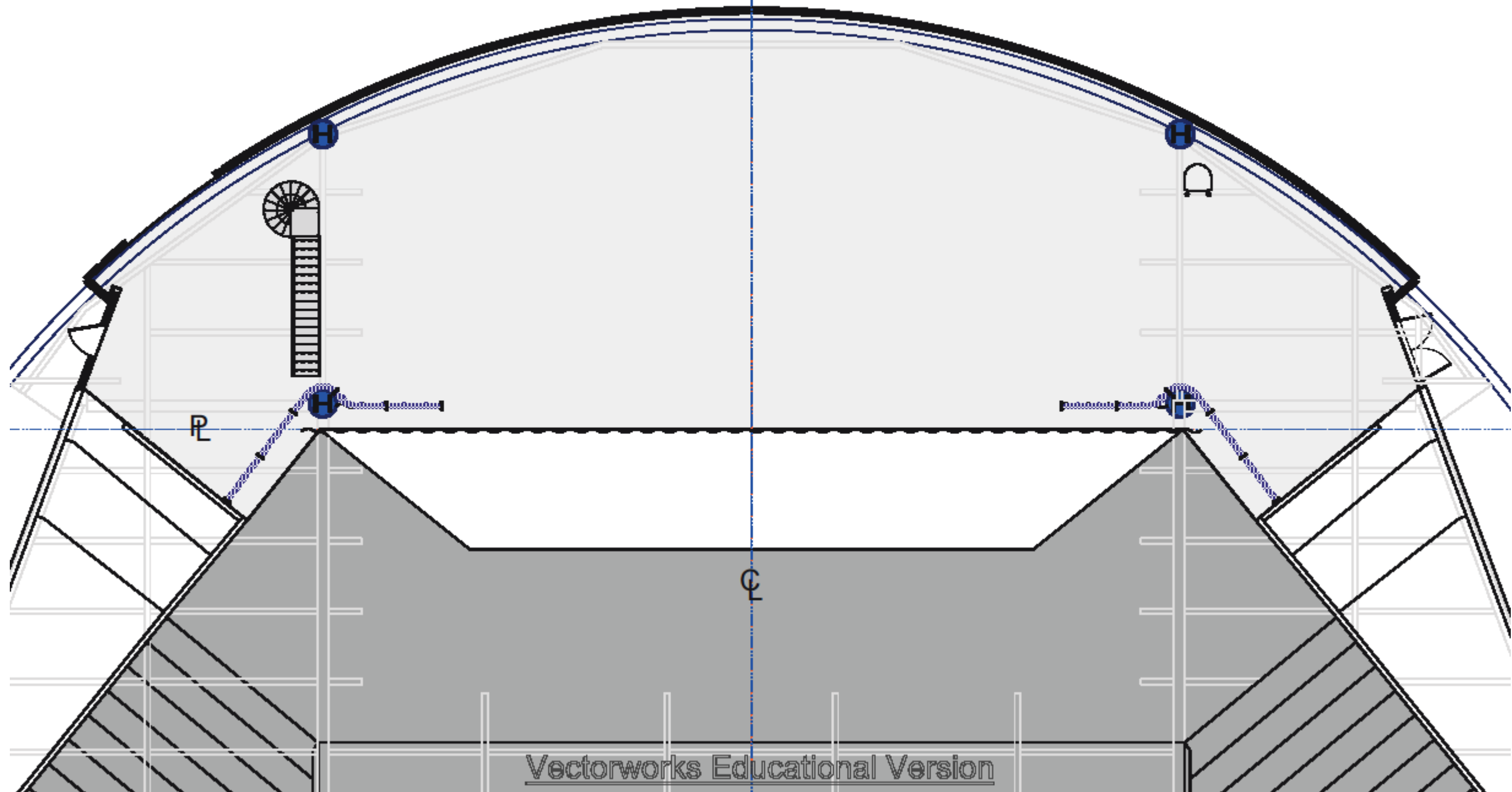
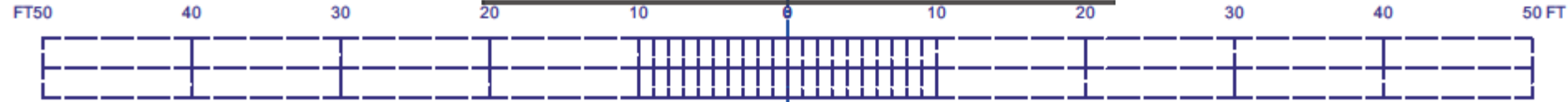

Vectorworks Educational Version

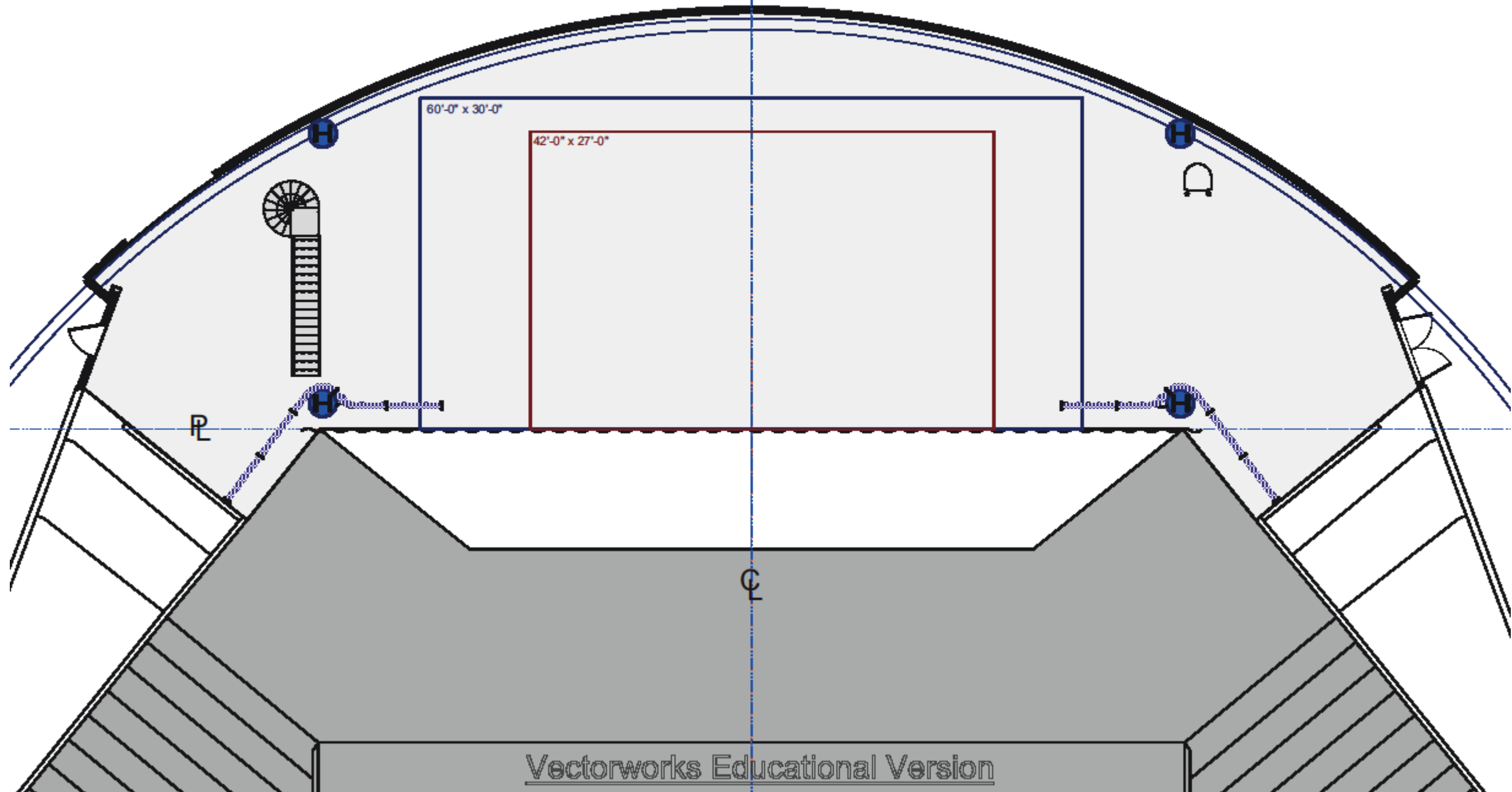
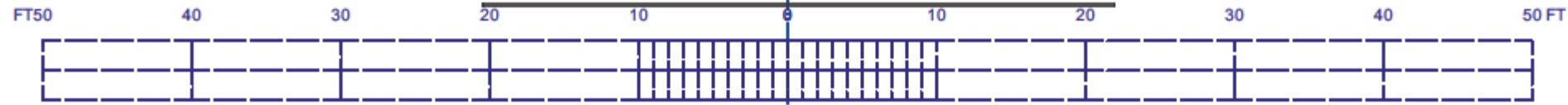

Vectorworks Educational Version

FT50 40 30 20 10 0 10 20 30 40 50 FT

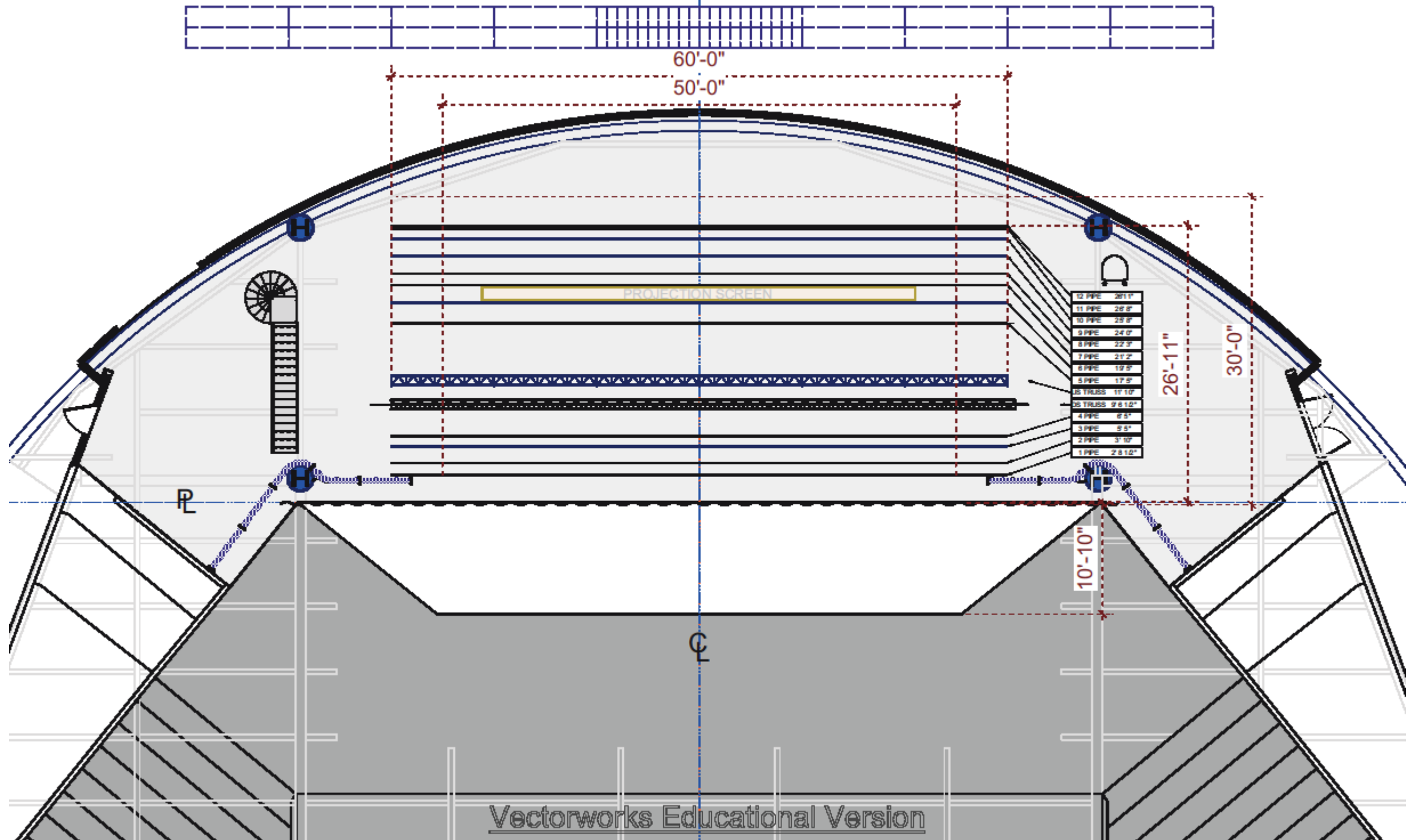

Vectorworks Educational Version

Vectorworks Educational Version

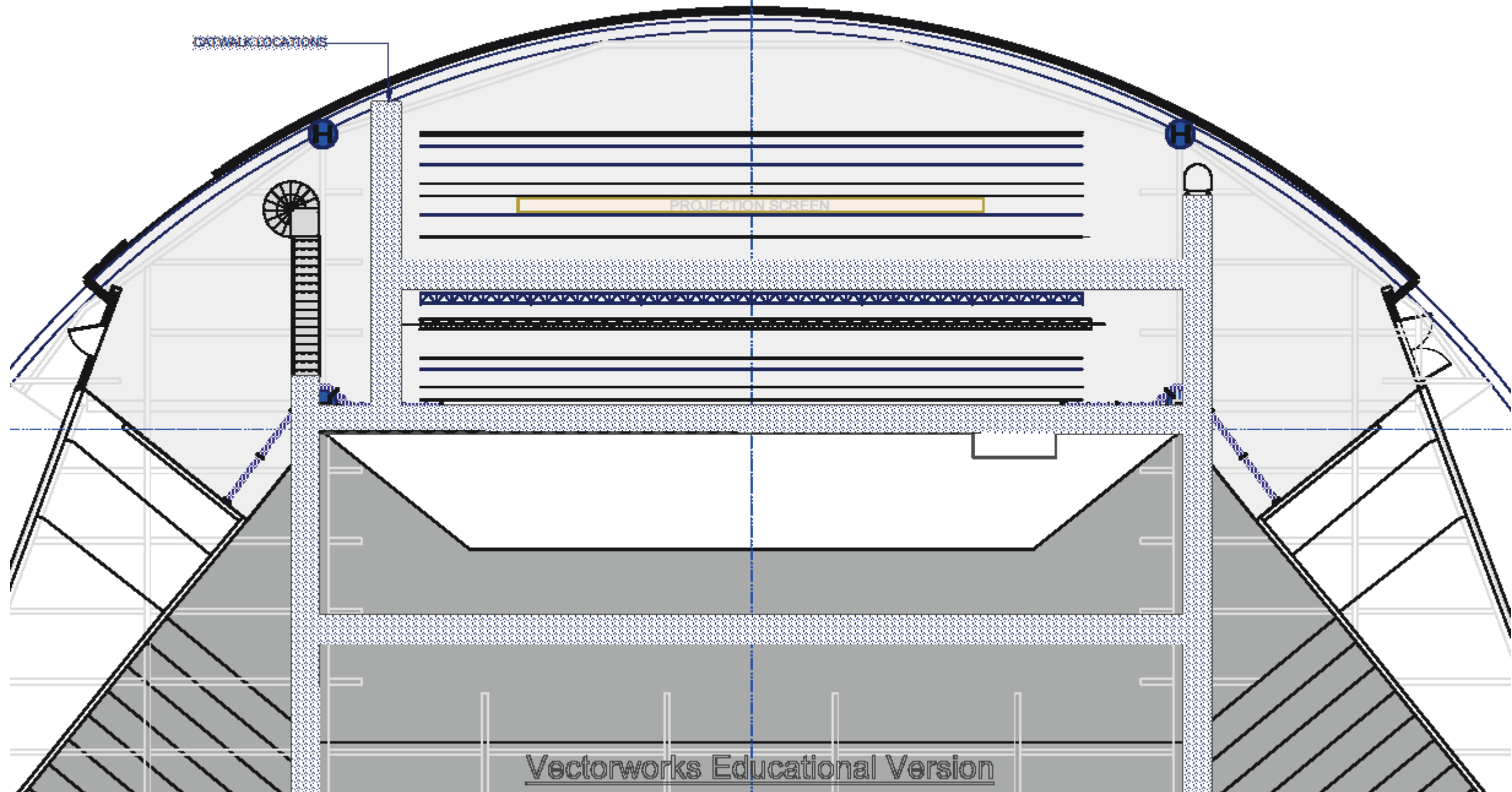
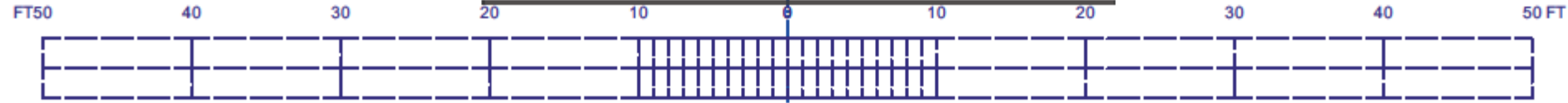

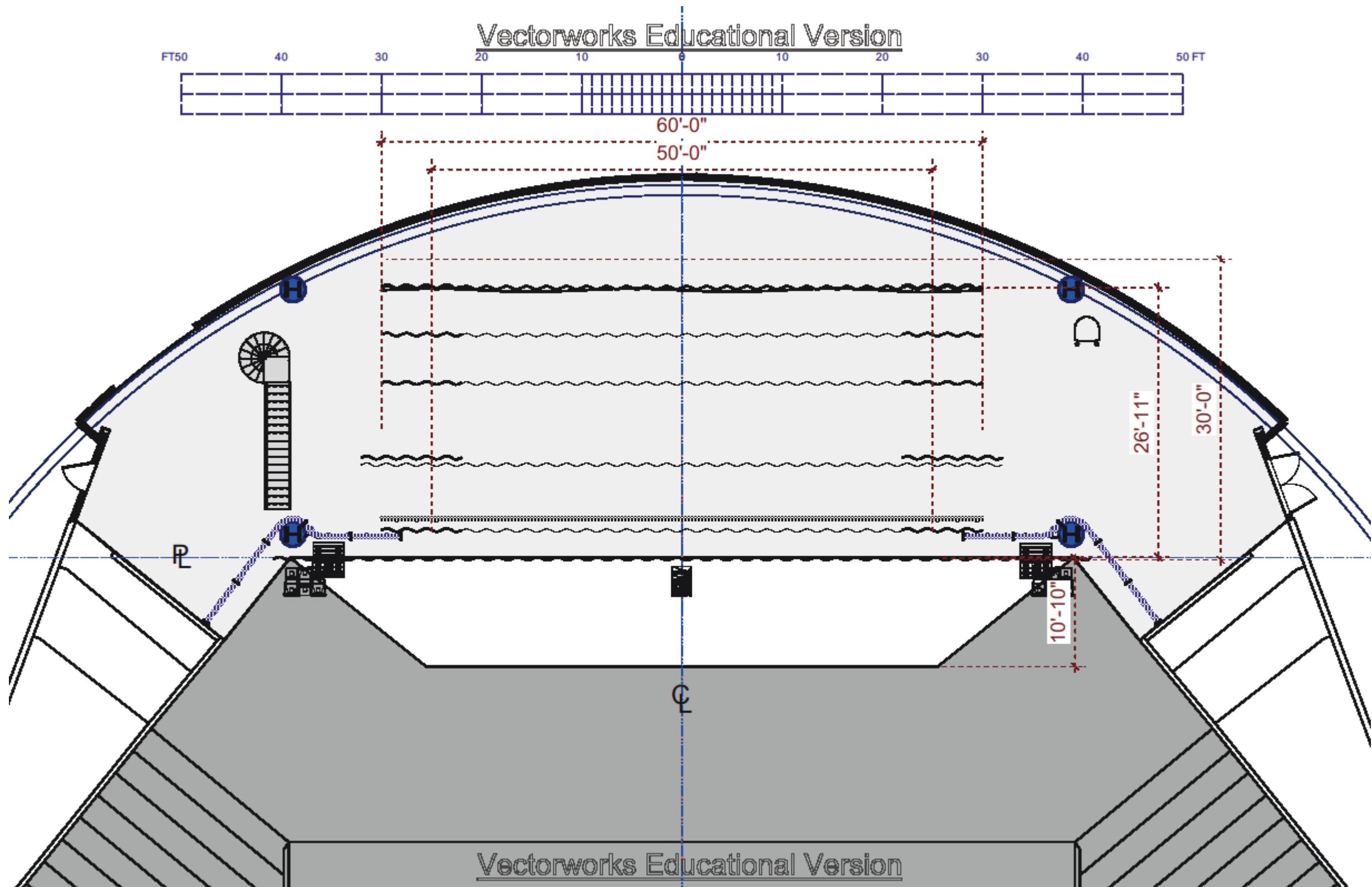

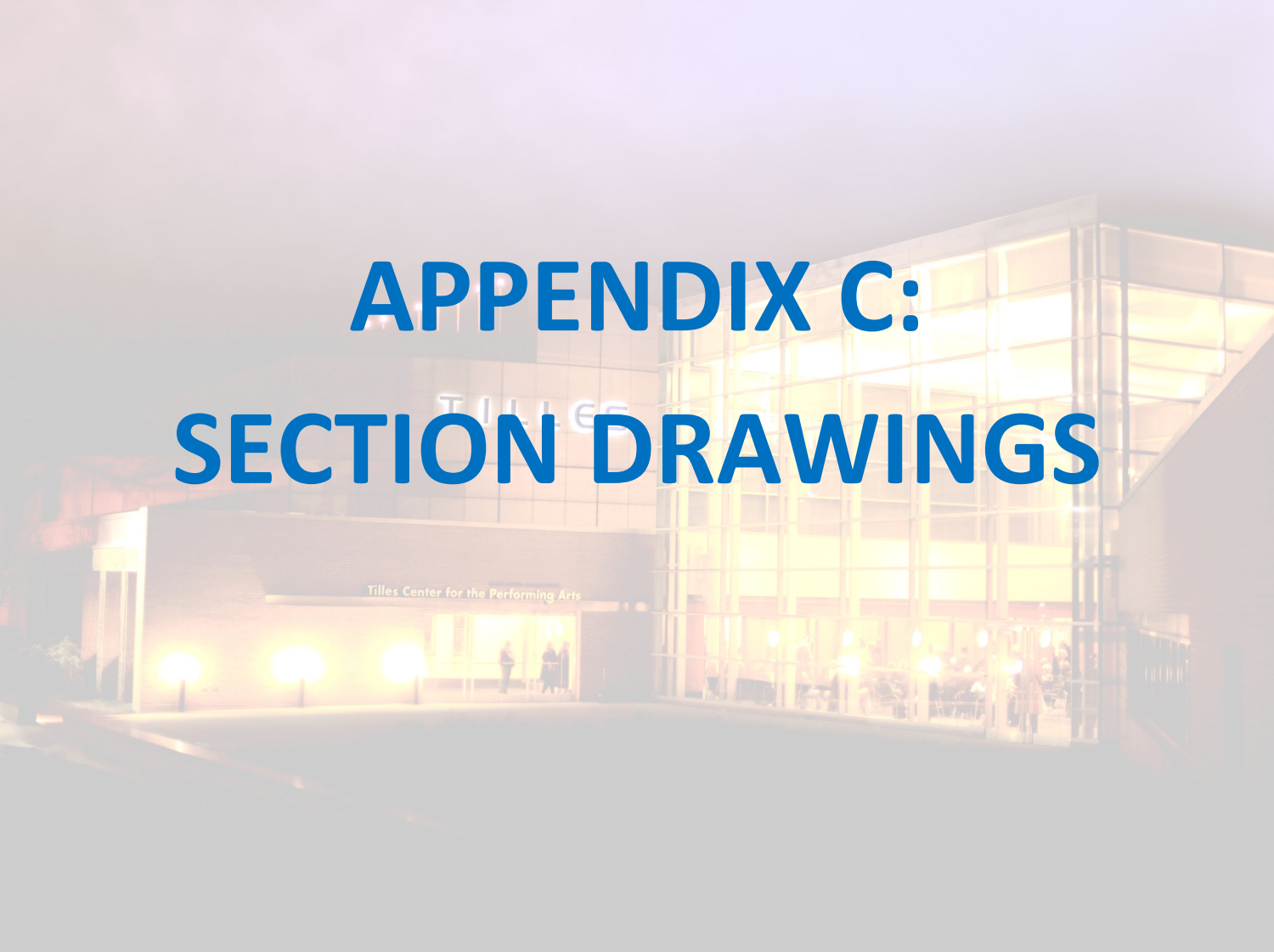

APPENDIX C: SECTION DRAWINGS

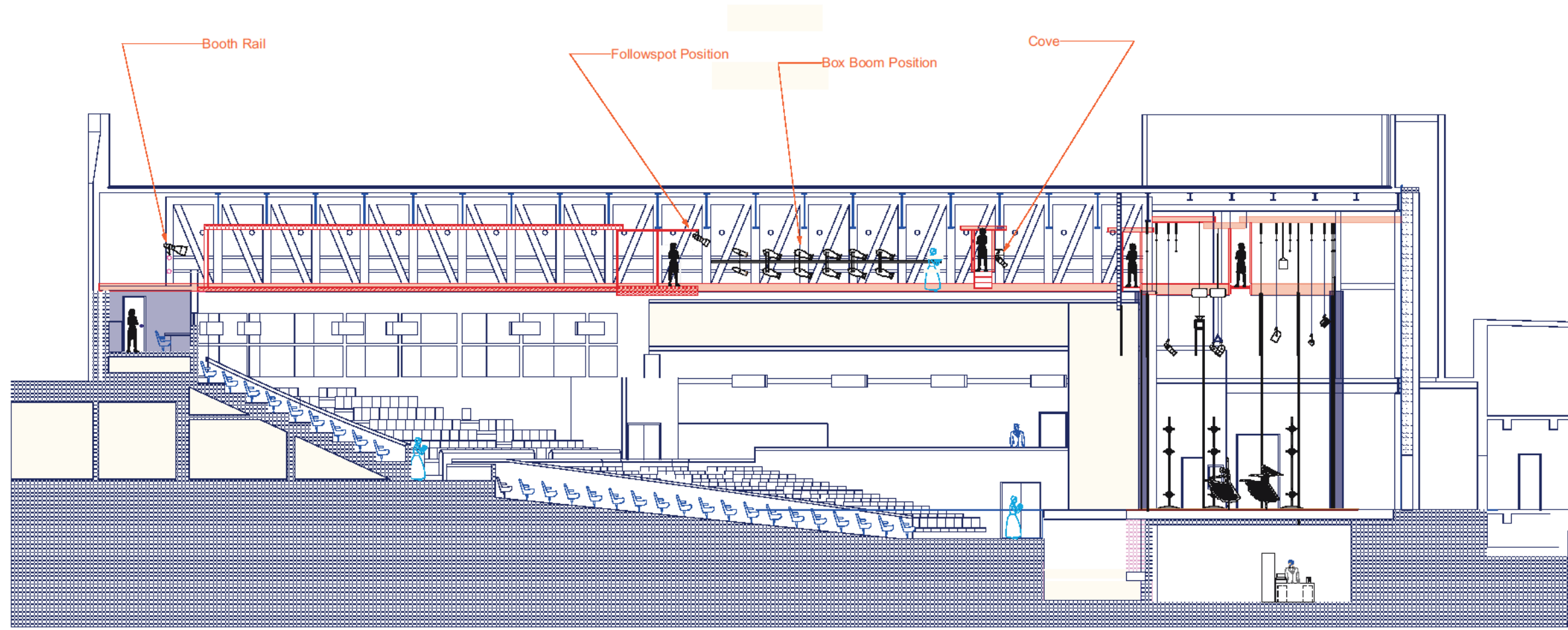

TillesCenter for the Performing Arts LIU Post	Tilles Center For The Performing Arts Theater Section @ Center (1/8" = 1'- 0")
	<small>Drafted By Thomas A. Pasanide</small> <small>MAR 2021</small>

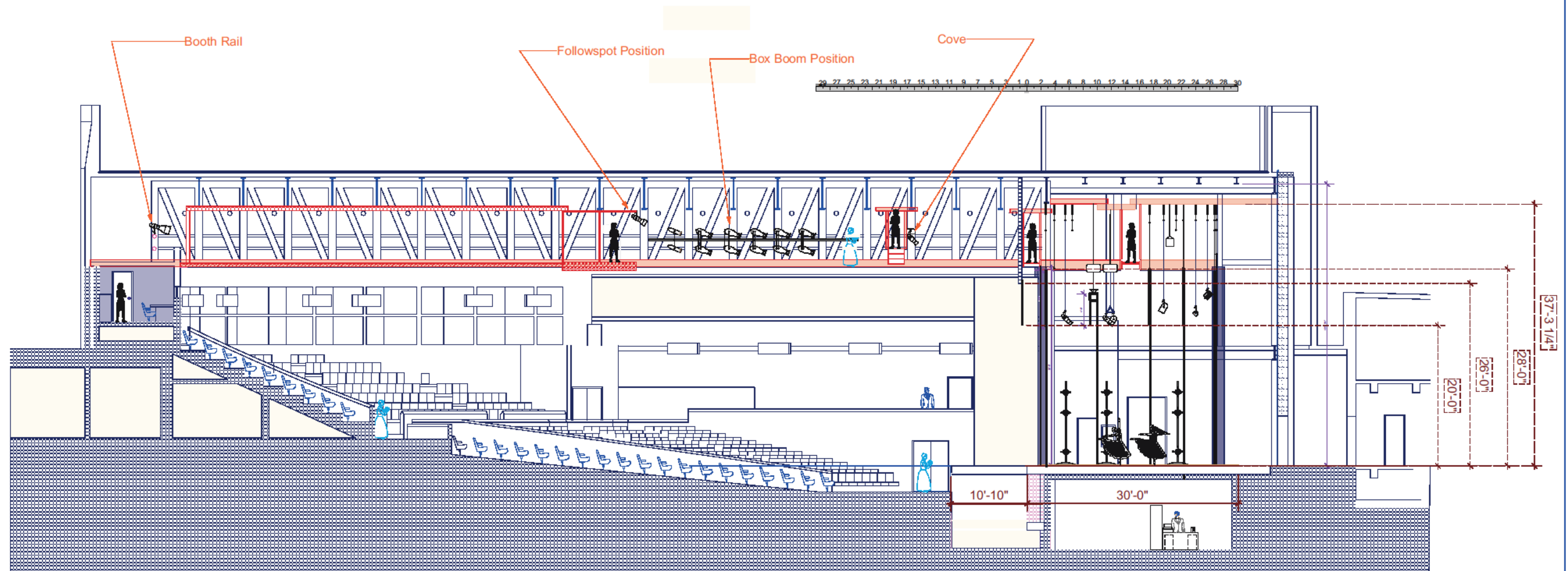

TillesCenter for the Performing Arts LIU Post	Tilles Center For The Performing Arts Theater Section @ Center (1/8" = 1'- 0")
	<small>Drafted By Thomas A. Pasarek</small> <small>MAR 2021</small>

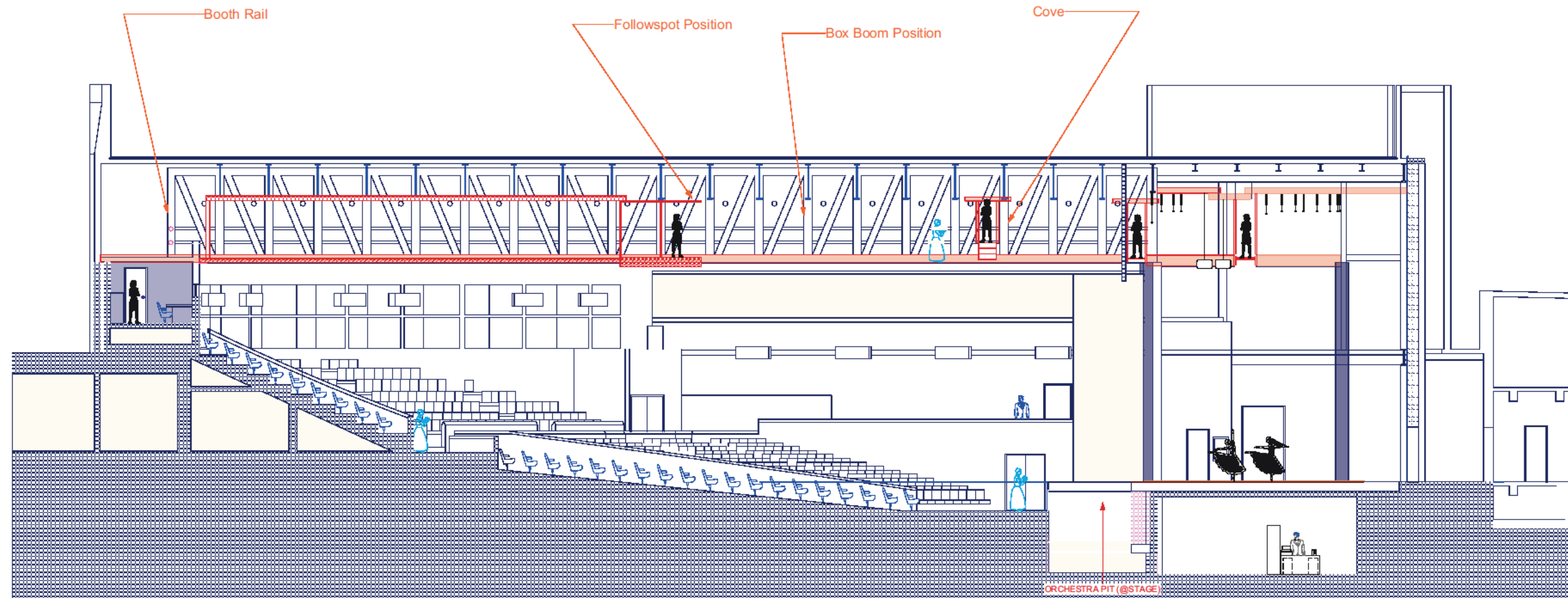

<p>TillesCenter for the Performing Arts LIU Post</p>	<p>Tilles Center For The Performing Arts Theater Section @ Center (1/8" = 1'- 0")</p>
	<p><small>Drafted By: Thomas A. Pincus</small></p> <p><small>MAR 2021</small></p>

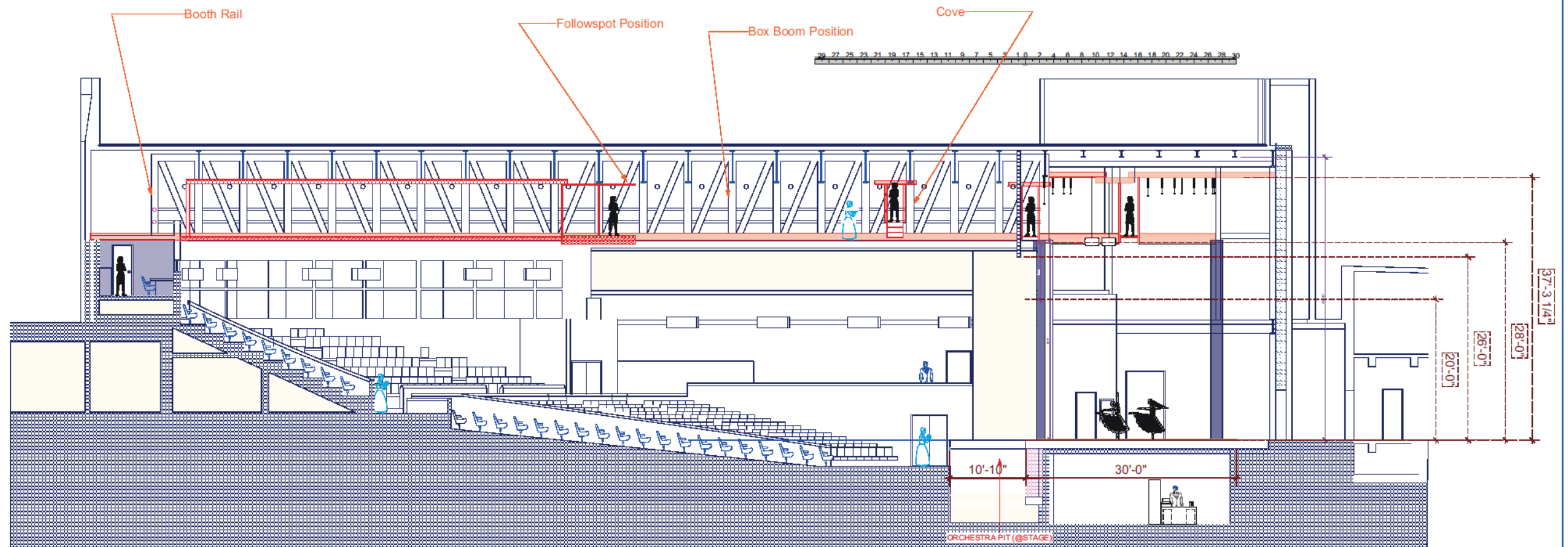

TillesCenter for the Performing Arts LIU Post	Tilles Center For The Performing Arts Theater Section @ Center (1/8" = 1'- 0")
	<small>Drafted by Thomas A. Pasorek</small> <small>MAR 2021</small>



**APPENDIX D:
RIGGING & LINESET
SCHEDULE**

Show: _____ **Perf. Date:** _____
Series: _____ **Stage Type:** _____

Typical House Hang	Line Set	Dist. U.S.	Max OUT	Show Hang	Notes
Portal Legs & Border 22'-0" O.C.	1	2' 8 1/2" (00.83m)	33' 6" (10.21m)		
Main Traveler	2	3' 10" (1.17m)			
1st Electric 24 Circuits	3	5' 5" (1.65m)	35' 0" (10.67m)		
Spare	4	6' 5" (7.62m)			
Legs & Border 22'-0" O.C.	Drapery Truss	9' 6 1/2" (2.91m)	25' 0" (7.62m)		
2nd Electric 20 Circuits	Electrics Truss	11' 10" (3.61m)			
Legs and Border 22'-0" O.C.	5	17' 5" (5.31m)	35' 0" (10.67m)		
3rd Electric 21 Circuits	6	19' 5" (5.92m)			
Spare	7	21' 2" (6.45m)			
Legs & Border 22'-0" O.C.	8	22' 3" (7.09m)			
4th Electric 12 Circuits	9	24' 0" (7.32m)			
5th Electric 24 Circuits (CYC LX)	10	25' 8" (7.82m)			
Soft Goods	11	26' 8" (8.13m)			
Soft Goods	12	26' 11" (8.20m)			
Goods Available for 11 & 12: White Muslin Cyc Full Stage Blackout Black Scrim	Notes:	1		Marley?: Main Pit None	
	-	2		Pit Info:	
		3			
		4			

Vectorworks Educational Version

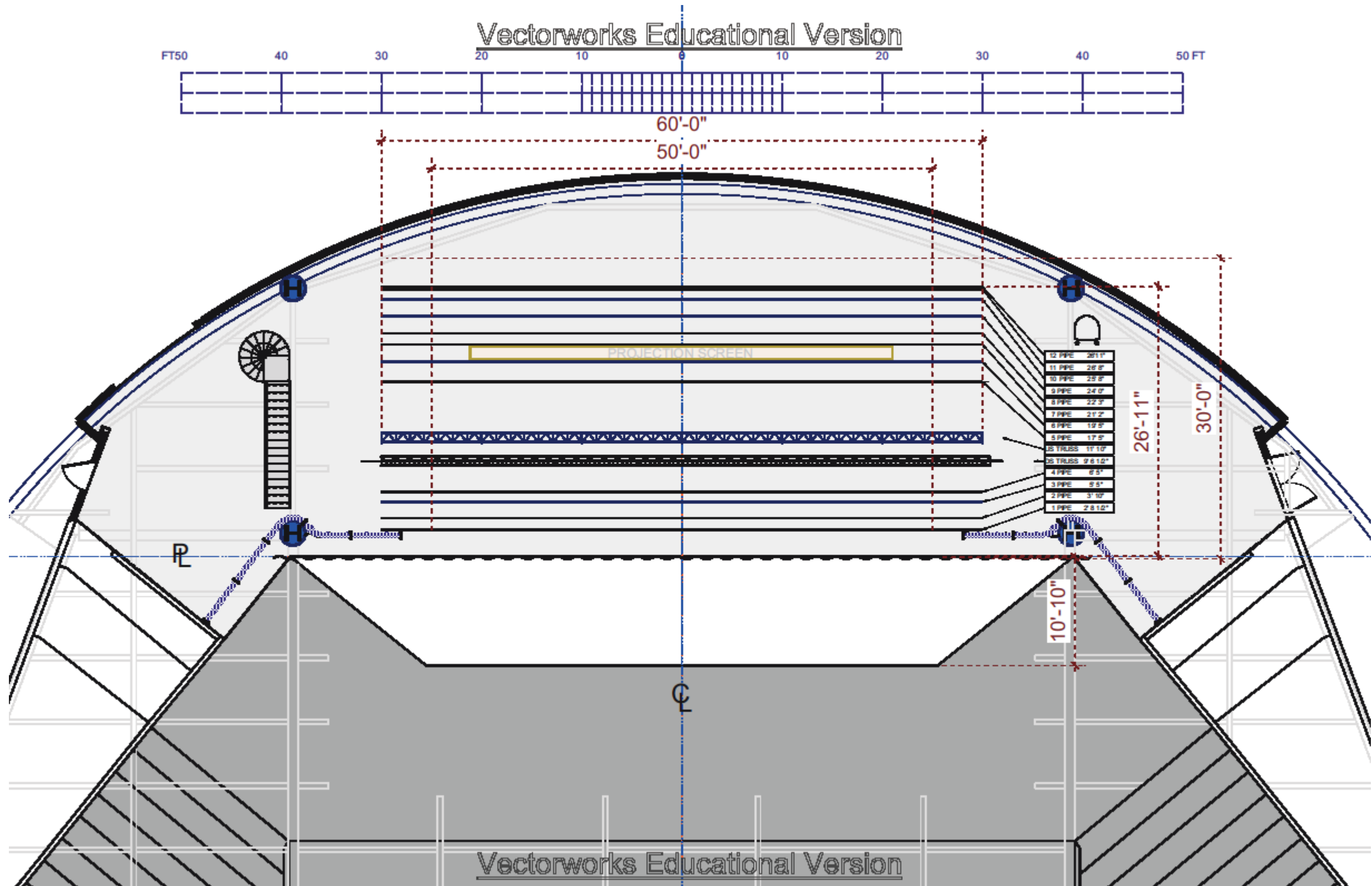

Vectorworks Educational Version

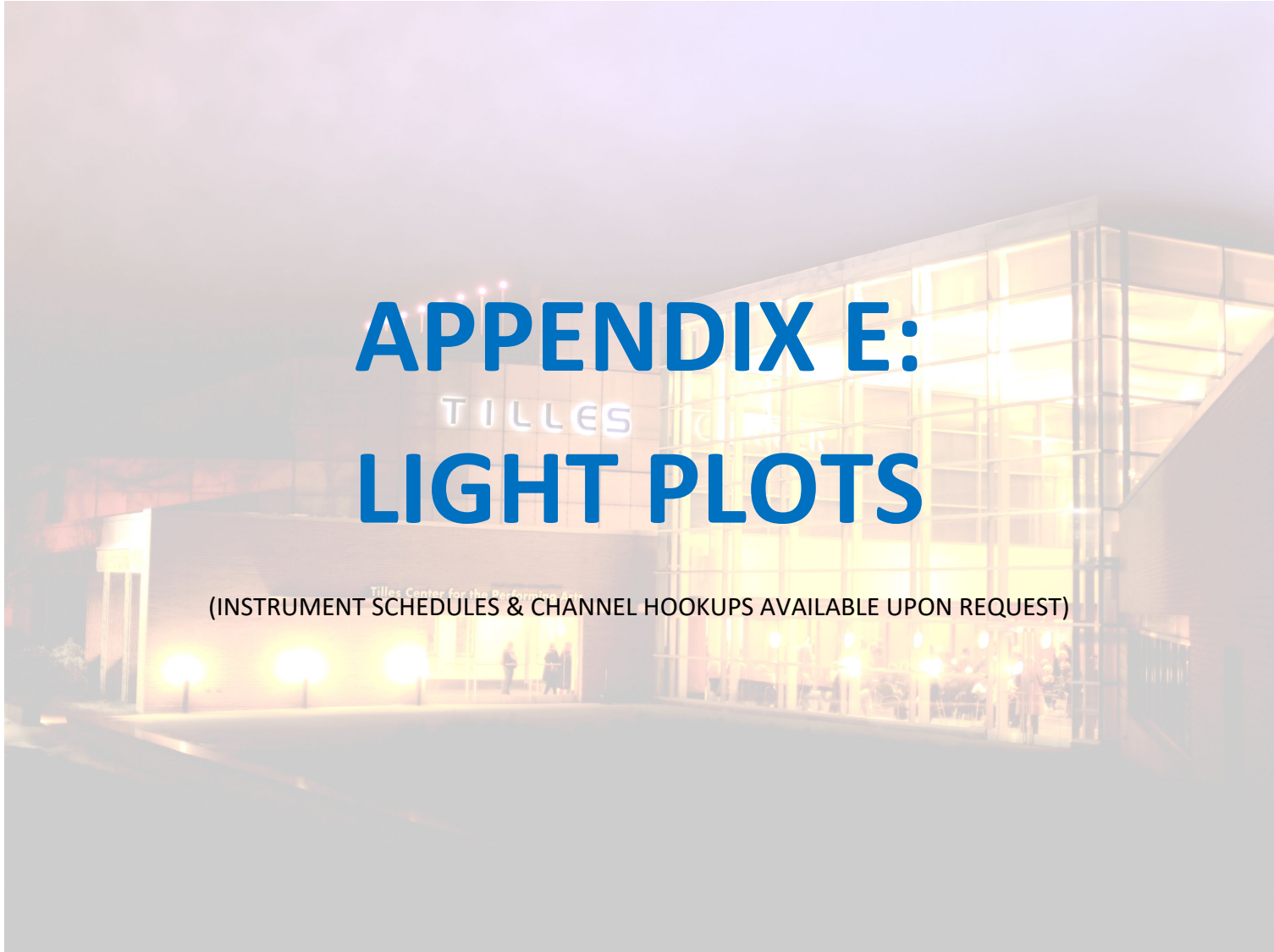











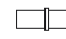
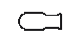

APPENDIX E: TILLES LIGHT PLOTS

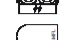
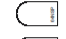

(INSTRUMENT SCHEDULES & CHANNEL HOOKUPS AVAILABLE UPON REQUEST)

Symbol Key

Accessory

Light

-  Altman 1KL10-5 @ 500-1000w
-  Altman 360Q 6x9 @ 750w
-  ETC Source-4 10' @ 575w
-  Etc Source 4 14' @ 750 w
-  ETC Source-4 19' @ 575w
-  ETC Source 4 26' @ 575w
-  ETC Source-4 36' @ 575w
-  Litscraft Stage Blinder P4 @ 430w
-  PAR 64 MFL @ 1KW
-  PAR 64 NSP @ 1KW
-  PAR 64 WFL @ 1KW
-  ETC Source 4 PAR MCM (NSP) @ 575w
-  ETC Source 4 PAR MCM (VNSP) @ 575w
-  ETC Source 4 PAR MCM (MFL) @ 575w
-  ETC Source 4 PAR MCM (WFL) @ 575w

-  Strong Super Trouper Medium @ 1-1.6kw
-  Altman Shakespeare Zoom 15-35' @ 600w

Moving Light

-  Martin Mac Aura @ 260w
-  Martin Mac Aura XB @ 359w
-  MAC Encore Performance CLD - Hung @ 600w

Static Accessory

-  6.25' Top Hat

Typical



Color Summary

Color Size Count

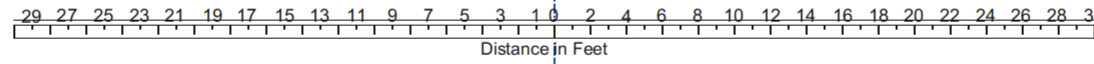

Deepest Point (34' - 9")

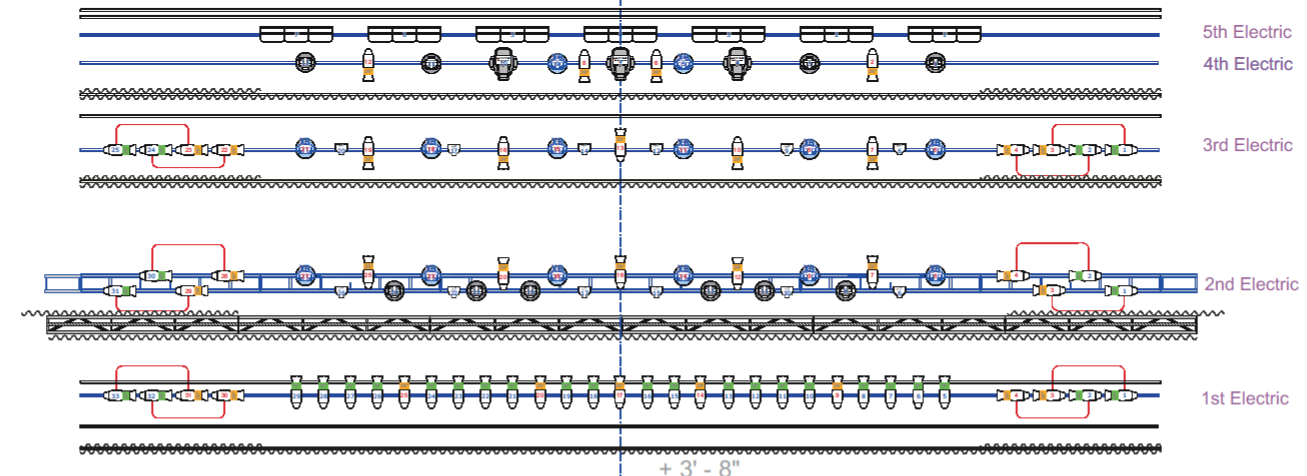

ORCHESTRA PIT
+3' - 8" → -8' - 1"

Pit Edge (+10'10")

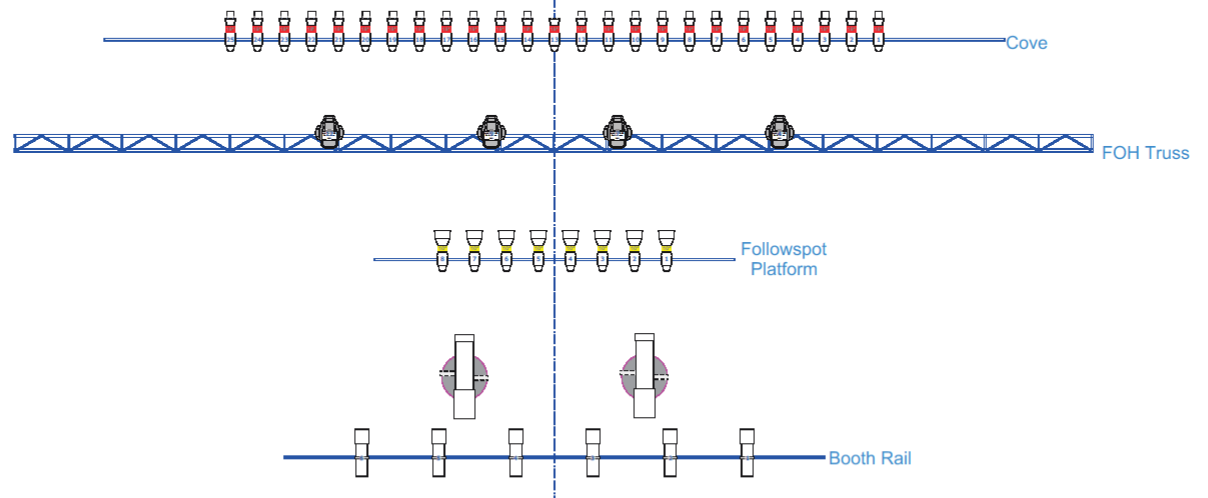
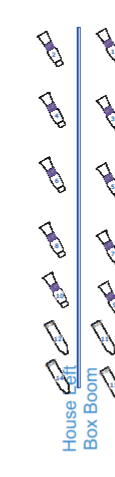
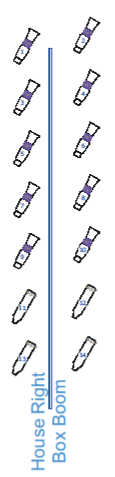

TillesCenter
for the Performing Arts LIU Post

FEBRUARY 2021
1/4" = 1'-0"

Ground Plan/RCP (Scale Varies by Format)

All Instruments on 1'-6" Center unless noted
Note: Turn Off "Shading" Class To Capture Instruments in Workspace

Dir Facility & Production: Thomas A. Pascarella
Production Managers: Giovanni Reres Kane Chiang
thomas.pascarella@liu.edu
giovanni.reres@liu.edu
kane.chinag@liu.edu

REP LIGHTING PLOT

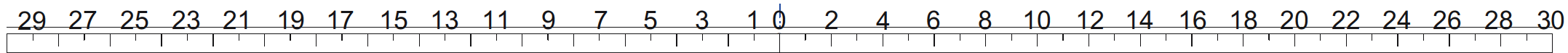

Distance in Feet

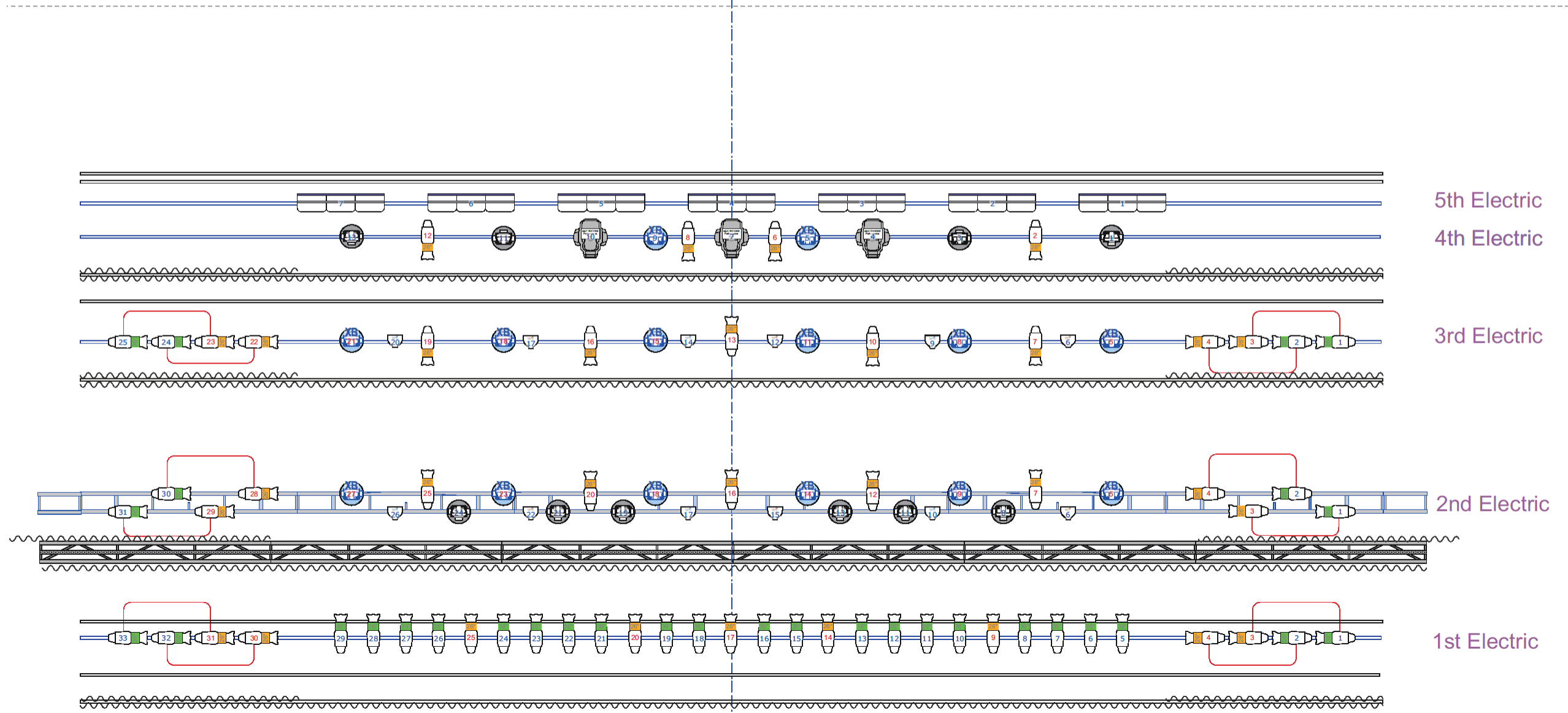

5th Electric

4th Electric

3rd Electric

2nd Electric

1st Electric



APPENDIX F: SEAT CHARTS

COMING SOON



